

SCHEDULE "A"

THE CITY OF BRANDON, A.R. MCDIARMID CIVIC COMPLEX
638 Princess Avenue, Brandon

SPECIFICATIONS AND INSTRUCTIONS FOR BUILDING CLEANING CONTRACT

CLEANING SCHEDULES

ADMINISTRATIVE OFFICES – MONDAY to FRIDAY

Floors

Location	Remove Spots & stains	Sweep With Broom & or dry mop	Damp mop	Clean & polish	Hand wash with cleaner	Machine wash with cleaner & refinish	Mobile carpet cleaner Deep steam clean	Vacuum	Disinfect with approved cleaner
All flooring	AR	D	D	AR	D	Q			AR
Carpet in high traffic areas	AR						SA	D	
Carpet in cubicles and offices	AR						SA	W2	
Ceramic tile	AR	D	D		SA	SA			
Ceramic tile base	AR				M				
Elevator floor	AR						SA	W	
Rubber base	AR				M				
Stairs & landings	AR	W	W						
Vinyl floor	AR	D	D		D	SA			
Washroom floor	AR	D			D	SA			W
Basement hallway tile floor		M	M			SA			
Basement stairs		M	M						

Glass & Fixtures

Location	Remove spots & stains	Clean & polish	Dust	Clean & disinfect with approved cleaner
Doors	AR	M		
Elevator, buttons & walls	AR	AR		M
Entrance Glass	AR	W2		
High fixtures	AR	M		
Kick plates	AR	M		
Picture frames, charts etc.	AR		M	
Remaining glass surfaces	AR	W2		
Steel surfaces	AR	W2		
Washroom stalls	AR	W2		M
Washroom tiles	AR	AR		D
Washroom-sinks, toilets, urinals, fountains & seats	AR			D
Windows – interior/exterior	AR	SA		
Windows – Office	AR	M		
Woodwork	AR	M		

Walls, Partitions & Doors

Location	Remove spots, stains	Wipe clean	Vacuum	Disinfect with approved cleaner
Doors	AR	M		
Door handles & light switches	AR	M		W2
Partitions	AR	M	Q	
Walls	AR	M	Q	

Furnishings

Location	Remove spots & stains	Dust	Hand clean with approved cleaner	Dry wipe	Damp wipe & re-polish	Vacuum	Empty & put in designated area	Disinfect with approved cleaner
Blinds & drapes				Q		Q		
Ceiling air grills		SA	SA					
Coat racks		M	AR					
Counters & appliances	AR		D					D
Door mats						D		
Front counters	AR	D	D					D
Furniture (desks, tables)	AR	W2	W		Q			
Hand rail		W	AR					
Lamps		W	AR					
Ledges, shelves, stair railings & window sills	AR	W	AR					
Recycle baskets			M				D	M
Shoe racks & trays			W					
Upholstered furniture (chairs)						M		
Upholstered Furniture – Legs	AR		M					
Walls & ceilings	AR	SA						
Waste baskets & receptacles			W				D	M
Compost bin			AR				AR	AR

Miscellaneous

Location	Maintenance compatible with finish	Re-stock supplies	Refill hand soap	Hand clean with approved cleaner	Disinfect with approved cleaner	Move from loading dock to street
Stained surfaces	AR					
Drinking fountain				D	D	
Automatic door switch					W	
Washroom		D	D			
Washroom fixtures (paper towel dispenser, soap dispenser, hand blowers, lids to garbage cans, garbage cans, etc.)				D	D	
Garbage Dumpster						W

YOUTH AND CULTURAL CENTRES (Monday – Friday)

Floors

Location	Remove Spots & stains	Sweep With Broom & or dry mop	Damp mop	Clean & polish	Hand wash with cleaner	Machine wash with cleaner & refinish	Disinfect with approved cleaner
Youth Centre	AR	D	D	AR		W2	
Cultural Centre	AR	D	D	AR		W	
Kitchen	AR	D	D	D		W2	
Bathrooms	AR	D	D	AR	D	SA	D
Entrance	AR	D	D	W		W2	
Vinyl Floor	AR	D	D		D	SA	

Glass & Fixtures

Location	Remove spots & stains	Clean & polish	Dust	Clean & disinfect with approved cleaner
Baseboards	AR	AR		
Doors & Light switches	AR	D		D
Door Handles				D
Entrance Glass	AR	W2		D
High fixtures	AR	M		
Kick plates	AR	M		
Picture frames, charts etc.	AR		M	
Remaining glass surfaces	AR	W2		
Steel surfaces	AR	W		
Washroom stalls	AR	W2		M
Washroom tiles	AR	AR		D
Washroom-sinks, toilets, urinals, fountains & seats	AR			D
Windows – interior/exterior	AR	M		
Windows – Office	AR	W		
Woodwork	AR	M		

Walls, Partitions & Doors

Location	Remove spots, stains	Wipe clean	Clean & Disinfect with approved cleaner
Doors	AR	M	
Door Handles	AR		D

Furnishings

Location	Remove spots & stains	Dust	Hand clean with approved cleaner	Dry wipe	Damp wipe & re-polish	Vacuum	Empty & put in designated area	Disinfect with approved cleaner
Blinds & drapes				Q		Q		
Ceiling air grills		SA	SA					
Coat racks		M	AR					
Counters & appliances	AR		D					D
Door mats						D		
Front counters	AR	D	AR					D
Furniture (desks, tables)	AR	D	D		Q			
Hand rail		W	AR					
Lamps		W	AR					
Ledges, shelves, stair railings & window sills	AR	W	AR					
Recycle baskets		M	AR				D	W
Shoe racks & trays			W					W
Upholstered furniture (chairs)			BW			BW		
Upholstered Furniture – Legs	AR		M					
Walls & ceilings		SA						
Waste baskets & receptacles		M	W				D	W
Compost bin			AR				AR	AR

Miscellaneous

Location	Maintenance compatible with finish	Re-stock supplies	Refill hand soap	Vacuum	Clean & Disinfect with approved cleaner
Sound Baffles				SA	
Light Fixtures					SA
Water Fountains					D
Bathroom Change Tables					W
Automatic Door Switch					W
Canteen – sink, counters, cabinet door handles, floor					D
Washroom fixtures (paper towel dispenser, soap dispenser, hand blowers, lids to garbage cans, garbage cans, etc.)					D
Stained surfaces	AR				
Washroom		D	D		

D – Daily
W – Once per week
W2 – Twice per week
BW – Bi-weekly
M – Monthly
Q – Quarterly
SA – Semi annual
AR – As required
Y – Yearly

NOTE: Two (2) days notice shall be provided to the Contract Administrator prior to any monthly, quarterly, semi-annual or yearly tasks performed. Any “as required” tasks shall be completed at minimum every quarter.

*** Recyclables** are to go in recycle bins only. All garbage bins are to be kept from overflowing and to be kept in an orderly and organized manner to ensure easy pickup with trucks.

****Clean all carpets in building with the use of a mobile carpet cleaning plant using a steam extraction system. (NOTE: Dry powder application will not be accepted.)**

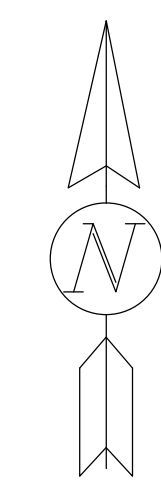
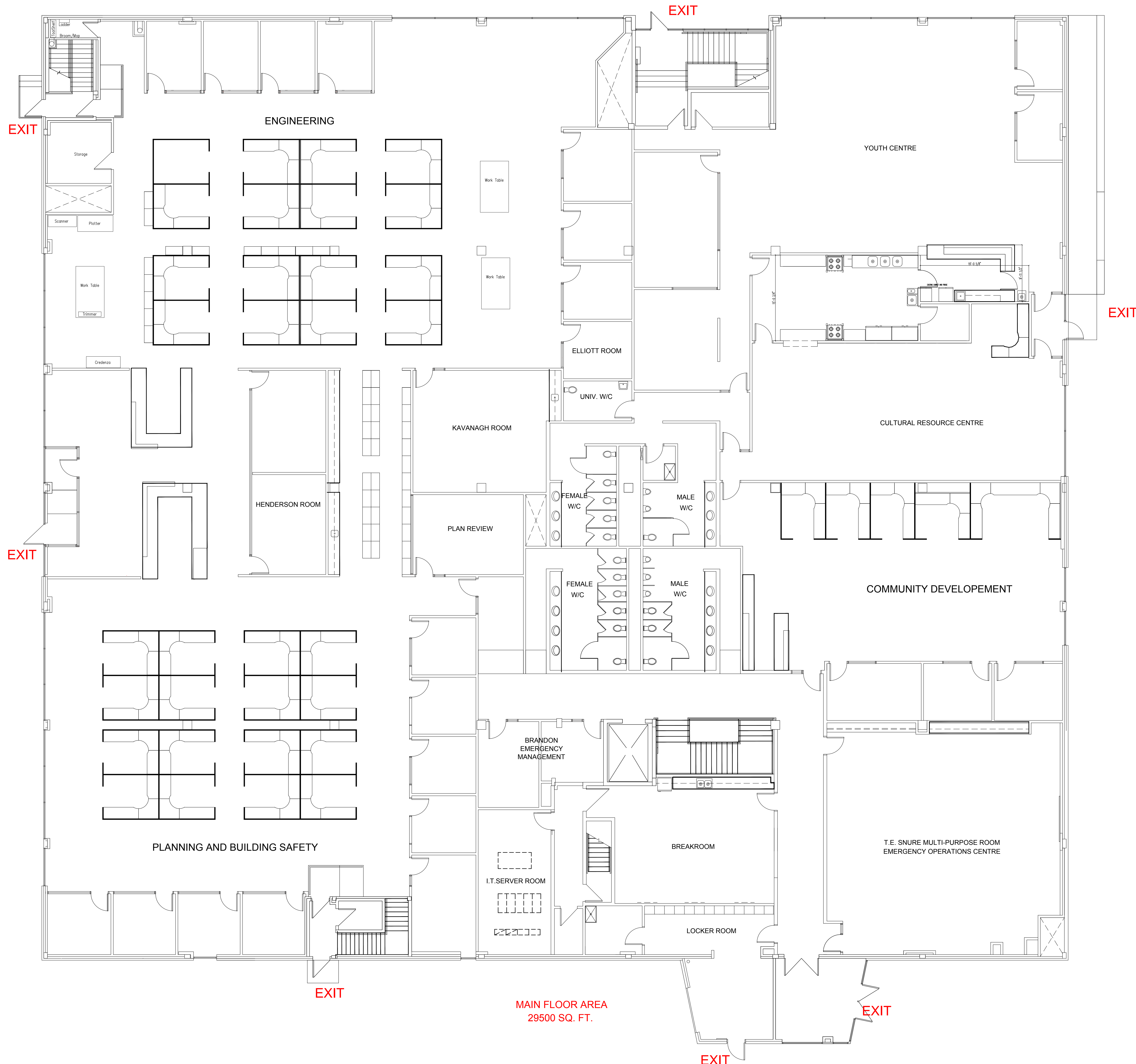

MAIN FLOOR AREA
29500 SQ. FT.

Main Floor Plan

No. DATE REVISION / ISSUANCE

Architect

Engineer



Project
A.R. MCDIARMID
CIVIC COMPLEX
638 Princess Ave.
Brandon, Manitoba

Sheet Title
Main Floor Plan

Project No. Sheet
Date 09/10/2014
1

Princess Ave

7th Street

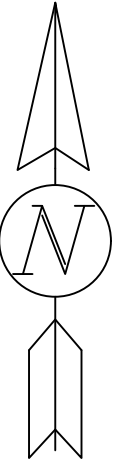
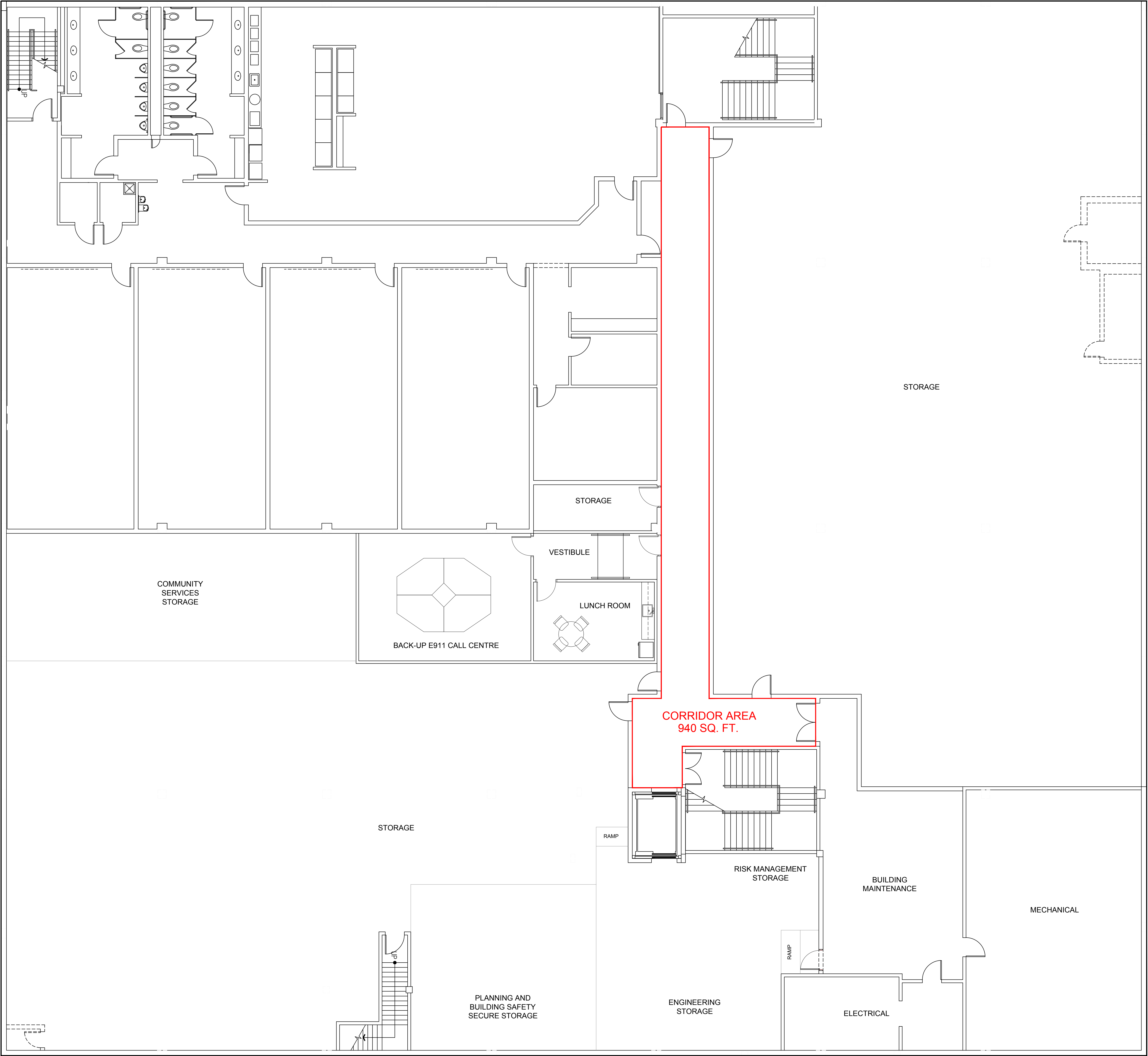

Basement Floor Plan

No.	DATE	REVISION / ISSUANCE

Architect

Engineer

City of BRANDON

Project

A.R. MCDIARMID CIVIC COMPLEX

638 Princess Ave.
Brandon, Manitoba

Sheet Title

Lower Floor Plan

Project No.

Sheet

Date

02/04/2016

1

THIS AGREEMENT made in duplicate this day of 2019.

BETWEEN:

(hereinafter called the "Contractor")
of the first part;

-and-

CITY OF BRANDON

(hereinafter called the "City")
of the second part.

WHEREAS the City is the owner and manager of the premises known as A.R. McDiarmid Civic Complex located at 638 Princess Avenue, Brandon, Manitoba (hereinafter called the "Building"); and

WHEREAS the Contractor has submitted a Proposal for a contract to clean the Building, which tender has been accepted by the City;

NOW THEREFORE the City and the Contractor covenant and agree as follows:

- 1.0 The Contract Documents consists of all the documents listed as follows:
 - i. This Agreement
 - ii. RFP Item #L-42/19
 - iii. Contractor's Response to Proposal
 - iv. Schedule "A" Specifications
- 2.0 The Contractor covenants and guarantees to provide the complete cleaning services for the Building in accordance with specifications attached hereto as Schedule "A" which shall form an integral part of this Agreement and, to supply all labour, materials, equipment and supervision of its employees necessary therefore, throughout the Term hereof at and for the total consideration of _____ including the Goods and Services Tax.
- 3.0 The City agrees to pay to the Contractor the said sum of _____ plus the Goods and Services Tax _____ in equal monthly instalments of _____ each payable on the last working day of each month commencing January, 2020. The Contractor will provide invoices to the City on a monthly basis. The above amount to be paid is based on the working of _____ hours per month.
- 3.1 The City reserves the right to request proof of the number of hours worked on a monthly basis at the building. Example: payroll records, timesheet, logs, etc..
- 4.0 This Agreement shall be in effect for a term commencing on the 15th day of January, 2020 and expiring on the 14th day of January, 2022. ("Initial Term") with the option to renew thereafter for a term of one (1) year on similar conditions as the Initial Term, upon the written request of the City and with written acceptance by the Contractor.
- 4.1 The City shall not incur any liability should it choose not to exercise its exclusive option to extend this Agreement.
- 5.0 In the event that the basic minimum wage in the Province of Manitoba, as set by Provincial Legislation, is increased during the term hereof, the City agrees that the monthly wage allotment of _____ shall be increased by the same percentage as the increase to the minimum wage for any payments to the Contractor made subsequent to any such increase.
- 6.0 The Contractor will be given a grace period of ten (10) working days to learn the building and refine cleaning methods. The Contractor will then be expected to comply fully with the cleaning requirements outlined in Schedule A.

Initials

- 6.1 The City will charge a fixed sum of \$50.00 per scheduled working day for Defective Work.
- 6.2 The fee for Defective Work and Inspections will be deducted from the monthly payment that is made to the Contractor.
- 7.0 The City will perform Building Cleaning Inspections once a week on random days. In addition to the fixed sum for Defective Work for this Contract, the City, at their discretion, will impose an inspection fee of \$25.00 per cleaning inspection for all additional inspections required to ensure compliance with Schedule A.
- 8.0 The Contractor shall, without limiting its obligations or liabilities herein and at its own expense, provide and maintain throughout the Contract term hereby granted the following insurance with insurers licensed in the Province of Manitoba and in forms and amounts acceptable to the City.
- a) Commercial General Liability Insurance on an occurrence basis, in an amount not less than two million dollars (\$2,000,000.00) inclusive per occurrence against death, bodily injury and property damage arising directly or indirectly out of the Cleaning Services or operation of the Contractor, its employees and agents. The City shall be added to the policy as an additional named insured and the policy shall contain cross liability and severability of interests such that the coverage shall apply in the same manner and to the same extent as though a separate policy had been issued to each insured. The insurance will include, but not be limited to:
 - i. Premises and operators liability, broad from products and completed operations, owners and Contractors protective liability, blanket contractual, employees as additional insured's, broad from property damage, non-owned automobile, contingent employers liability, broad form loss of use, personal injury, and incidental medical malpractice.
 - b) Automobile Liability Insurance covering all motor vehicles, owned, operated and used or to be used by the Contractor directly or indirectly in the performance of the Work or cleaning services. The limit of liability shall not be less than two million dollars (\$2,000,000.00) inclusive, for loss or damage including personal injuries and death resulting from any one accident or occurrence.
 - c) All Risks Insurance for loss of or damage to all Contractor's equipment, owned or leased for which the Contractor may otherwise be responsible and used or to be used in the performance of the cleaning services. This insurance shall be for an amount not less than the replacement cost value of the equipment. In the event of loss or damage, the Contractor shall, if so requested by the City, forthwith replace such lost or damaged equipment. Such All Risks Insurance shall be endorsed to waive all right of subrogation against the City.
 - d) All insurance must be primary; and not require the sharing of any loss by an insurer of the City.
 - e) The Contractor's Worker's Compensation Number _____ must be in good standing, and maintained throughout the Term of this Agreement.
- 9.0 The Contractor agrees to indemnify, defend, save and hold harmless the City, including and without limitation, its Council members, agents, servants and employees from and against all suits, claims, demands, losses, damages, expenses and costs made against or incurred, suffered or sustained by the City at any time or times (either before or after the expiration or sooner termination of this Agreement) where the same or any of them are based upon or arise out of or from anything done or omitted to be done by the Contractor or by any servant, employee, officers, director or sub-contractor the Contractor pursuant to this Agreement; excepting always, liability out of the independent acts of the City.
- 10.0 The Contractor shall ensure an individual is at the Building at all times who is able to communicate effectively in the English language with the City.
- 11.0 The Contractor shall be responsible for compost disposal and shall ensure of emptying the compost as required and putting in the designated bins.

Initials

- 12.0 The Contractor shall not assign this Agreement or any rights in respect of the same to any other party. Such an assignment or purported assignment will immediately invalidate this Agreement.
- 13.0 For the purpose of this Agreement, any notice to the City by the Contractor shall be addressed to: The Building Maintenance Chargehand, 900 Richmond Avenue East, Manitoba, R7A 7M1 and any notice to the Contractor shall be addressed to:
- 14.0 In the event of a dispute arising between the City and the Contractor as to their respective rights and obligations under the Agreement, both parties agree to resolve the dispute by:
- a) Frank and open negotiations whereby both parties use their best efforts to resolve the dispute by mutual agreement including the most Senior Management of both parties.
- 15.0 The City reserves the right to cancel this Agreement upon thirty (30) days written notice to the Contractor if, at any time, the City is not satisfied with the quality of work being performed under this Agreement or if the Contractor fails to comply with any of the specifications attached hereto. All notices, instructions and approvals shall be issued by the City whose decision shall be final and binding upon both parties.
- 15.1 The Contractor has the right to cancel this Agreement upon thirty (30) days written notice to the City.
- 16.0 The City reserves the right to cancel this Agreement:
- a) Immediately upon written notice of, in the opinion of the City, the Contractor is not fulfilling the terms, conditions and specification of the Contract; or
 - b) More than three (3) written occurrences of complaints for Work performed from the City; or
 - c) If, in the sole opinion of the City, the Contractor at anytime during the duration of this Agreement, endangers the public safety; or
 - d) Unknown Personnel, sub-contractor or assignment of cleaning services to others; or
 - e) If the Contractor should be adjudged or bankrupt; or
 - f) If the Contractor should make a general assignment for the benefit of its creditors;
 - g) If a receiver should be appointed on account of the Contractor's insolvency; or
 - h) If the operational requirement of the City change for the Building.

In the event the City terminates this Contract:

- a) The City's liability shall be limited to only the Contractor fees and expenses for satisfactorily completed Work up to the date of termination and not thereafter; and
 - b) The City may enter into an Agreement, in its sole discretion, with another Contractor for the provisions of cleaning services.
- 17.0 The Contractor and any approved sub-contractors shall obtain and maintain a current City of Brandon Business Licence for the duration of the Contract.
- 18.0 The Contractor, its sub-contractors, the officers, directors, shareholders, partners, personnel, affiliates and agents of the Contractor and sub-contractors are not, nor are they to be deemed to be partners, appointees, employees or agents of the City.
- 19.0 a) The Contractor will bind all approved sub-contractors to the terms of the Agreement, as applicable to the sub-contractors Work.
- b) The Contractor will preserve and protect the rights of the City with respect to any

Initials

Work performed under sub-contract and incorporate the terms and conditions of this Agreement into all sub-contracts as necessary to preserve the rights of the City under this Agreement.

- c) The Contractor shall require each of its sub-contractors to provide comparable insurance to that set forth above in clause 8.0.
 - d) All sub-contractors, if any, are the responsibility of the Contractor.
 - e) The Contractor will be as fully responsible to the City for acts and omissions of sub-contractors and of persons directly or indirectly employed by them as for acts and omissions of persons directly employed by the Contractor.
- 20.0 a) The Contractor(s), their employees, agents and vehicles shall have and maintain permits and licenses as required by law for the execution of cleaning services related to this Agreement.
- b) Contractor will conform to all Federal, Provincial Acts, and City By-laws and Regulations that may apply to the cleaning services performed under this Agreement. The Contractor is required to obtain and pay for all necessary permits, licenses, and inspection fees.
- c) Certified copies of required permits/licenses will be available upon request by the City.
- 21.0 The City requires that a criminal record check be conducted by the Contractor on all individuals performing Work under this Agreement. The cost will be borne by the Contractor.
- 22.0 This Agreement shall enure to the benefit of and be binding upon the parties hereto, their heirs, executors, and administrators.
- 23.0 Time shall be of the essence in this Contract.

IN WITNESS WHEREOF the parties hereto have hereunto caused their signatures to be affixed by their duly authorized persons the day and year first above written.

“Authorized Signatory
I am authorized to bind the company.”

“Authorized Signatory
I am authorized to bind the company.”

THE CITY OF BRANDON

Initials

THIS AGREEMENT made in duplicate this day of
2019.

BETWEEN:

(hereinafter called the "Contractor"),
OF THE FIRST PART.

-and-

THE CITY OF BRANDON

(hereinafter called the "City"),
OF THE SECOND PART.

**A.R. MCDIARMID CIVIC COMPLEX
CLEANING AGREEMENT**

November 27, 2019

THE CITY OF BRANDON
Operations, Public Works Division
900 Richmond Avenue East
Brandon, Manitoba
R7A 7M1

Mark Yeomans
Director of Public Works, Operations

Telephone: 204-729-2292
Fax: 204-729-2485
Email: m.yeomans@brandon.ca



CONCRETE PROJECT THROUGH BODY PORCELAIN - RECTIFIED



ecotile

PRE-CONSUMER: 26%

Stocked Sizes	Price /sf	Price /pc
12"x 24" Matte	\$7.95	\$15.90
12"x 24" Textured	\$8.95	\$17.90
24"x 48" Matte & Textured	\$12.95	\$103.60

This series merges the textured appearance of concrete with the performance of porcelain.

CONCRETE PROJECT SERIES



	12" x 24" Matte	12" x 24" Textured	24" x 48" Textured	24" x 48" Matte
\$ / sf	\$7.95	\$8.95	\$12.95	\$12.95
\$ / ea	\$15.90	\$17.90	\$103.60	\$103.60
ALMOND	CPRMA1224	CPRTA1224		
EARTH	CPRME1224	CPRTE1224	CPRTE2448	CPRME2448
GREY	CPRMG1224	CPRTG1224		
LEAD	CPRML1224	CPRTL1224	CPRTL2448	CPRML2448

Alternate sizes, textures, décor and trim pieces may also be available for special order. Contact your sales consultant for more information.



Almond



Earth



Grey



Lead

RECOMMENDED APPLICATIONS

Residential	✓	Indoor	✓
Light Commercial	✓	Outdoor	✓
Heavy Commercial	✓	Wall	✓
Bath/Shower	✓	Floor	✓
Fireplace	✓		

CHARACTERISTICS OF TILE

50 year life span	Low Maintenance
Stain Resistant	Fade Resistant
Hypoallergenic	Resistant to fungus
Eco-friendly	Odour Resistant

All images are for reference only and may not match physical product exactly. All product specifications are supplied by the manufacturer and are subject to change by the manufacturer without notice to you or to Ames Tile & Stone Ltd. Ames makes no representations or warranties as to the specifications of any product. Prices are subject to change without notice; please contact your Ames Sales Consultant for current prices.

TECHNICAL SPECIFICATIONS

CGSB Type CANADIAN GENERAL STANDARDS BOARD	4 - Through body porcelain
PEI WEAR RESISTANCE OF GLAZED TILE	—
Variation V1 V2 V3 V4	Slight variation
Friction Coefficient SLIP RESISTANCE	Wet ≥0.60, Dry ≥0.60
Frost Resistance	Yes
MR rating MOISTURE RESISTANCE	1 (<0.05% – Impervious)
MOHS SCRATCH RESISTANCE SCALE	—
Thickness	1/2" or 11mm
Chemical Resistance	Resistant to household chemicals
Country of Origin	Italy
	PRE-CONSUMER 26%



SOHO GLOSS & MATTE WALL TILE

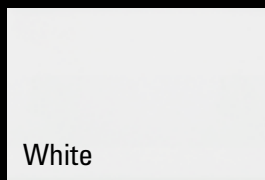
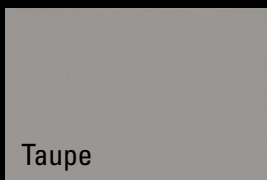
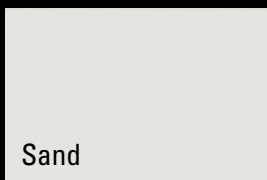
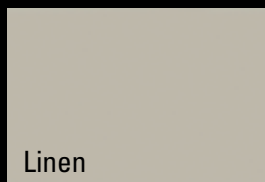
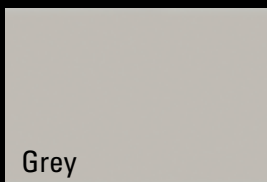
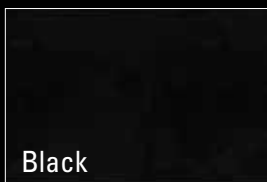

RETAIL PRICING LISTED

Stocked Sizes	Price /sf	Price /pc
3"x 6"	\$4.40	\$0.55
3"x 6" Black	\$4.80	\$0.60
4"x 16"	\$3.99	\$1.77
4"x 16" Black	\$4.79	\$2.13
2"x 2" Mosaics (12" x 12" mesh sheet)	\$5.95	\$5.95

The sleek appearance of the Soho Series gives a clean, contemporary feel to your space.

SOHO SERIES

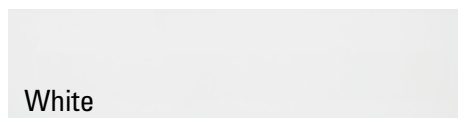
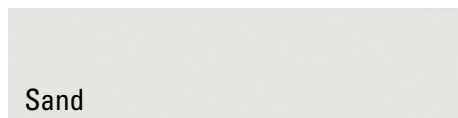

12" x 12" mesh sheet

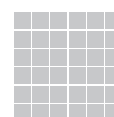

	3" x 6" Gloss	3" x 6" Gloss	3" x 6" Matte	4" x 16" Gloss	4" x 16" Gloss	4" x 16" Matte	2" x 2" Mosaics Matte Glazed Porcelain
\$ / sf	\$4.40	\$4.80	\$4.40	\$3.99	\$4.79	\$3.99	\$5.95
\$ / pc	\$0.55	\$0.60	\$0.55	\$1.77	\$2.13	\$1.77	\$5.95
BLACK		SOHBG36			SOHBG416		SOHBMM2
GREY	SOHGG36			SOHGG416			SOHGMM2
LINEN	SOHLG36			SOHLG416			SOHLMM2
SAND	SOHSG36			SOHSG416			SOHSMM2
TAUPE	SOHTG36			SOHTG416			SOHTMM2
WHITE	SOHWG36		SOHWM36	SOHWG416		SOHWM416	SOHWMM2

Alternate sizes, textures, décor and trim pieces may also be available for special order. Contact your sales consultant for more information.

RECOMMENDED APPLICATIONS

Residential	✓	Indoor	✓
Light Commercial	✓	Outdoor	✗
Heavy Commercial	WALL ONLY	Wall	✓
Bath/Shower	✓	Floor	MOSAICS ONLY
Fireplace	✓		

CHARACTERISTICS OF TILE

50 year life span	Low Maintenance
Stain Resistant	Fade Resistant
Hypoallergenic	Resistant to fungus
Eco-friendly	Odour Resistant

TECHNICAL SPECIFICATIONS

CGSB Type CANADIAN GENERAL STANDARDS BOARD	5 - matte & gloss wall
Variation V1 V2 V3 V4	Uniform appearance
Frost Resistance	No
MR rating MOISTURE RESISTANCE	Wall: 4 (7%-18% – Non-vitreous) Mosaics: 2 (0.5%-3% – Vitreous)
Thickness	1/4" or 6mm
Chemical Resistance	Resistant to household chemicals

All images are for reference only and may not match physical product exactly. All product specifications are supplied by the manufacturer and are subject to change by the manufacturer without notice to you or to Ames Tile & Stone Ltd. Ames makes no representations or warranties as to the specifications of any product. Prices are subject to change without notice; please contact your Ames Sales Consultant for current prices.

Inspire. Design. Create.
www.amestile.com/soho



Johnsonite®

LIMITED WARRANTY

WARRANTY AND LIMITATION OF LIABILITY – Johnsonite Flooring – The Tarkett Collection (excluding installation) sold hereunder is warranted by Johnsonite to be free from manufacturing defects in material for a period of five years from the date of original purchase. Floors must be professionally installed. Johnsonite should be notified in writing of any product claim within ten (10) days of the detection of any such defect.

- This warranty applies only for products used, installed and maintained according to the written recommendations and specifications issued by Johnsonite at the time of material purchase.*
- To verify that a manufacturing defect exists, inspection by an authorized Johnsonite representative will be required.*
- For verified defects in the first year, Johnsonite will supply to its distributor, without charge, new appropriate Johnsonite flooring material of the same or similar color, design and gauge for the defective areas and reasonable* labor.*
- For verified defects in the second year, Johnsonite will supply to its distributor, without charge, new appropriate Johnsonite flooring material of the same or similar color, design and gauge for the defective areas and pay 50% of the cost for reasonable* labor.*
- For verified defects in the third, fourth or fifth year, Johnsonite will supply to its distributor, without charge, new appropriate Johnsonite flooring material of the same or similar color, design and gauge for the defective areas.*
- If the defective material has been discontinued or is otherwise unavailable, Johnsonite reserves the right to select and supply similar Johnsonite Flooring replacement material.*

*NOTE: It is not recommended to install Johnsonite Flooring – The Tarkett Collection in work or commercial areas exposed to oil and grease, such as commercial kitchens and butcher shops. * Reasonable is defined as the average labor cost charged by flooring contractors in your area for similar types of repair or replacement.*

Excluded from Warranty

These warranties do not apply to the following:

- 1. The exact matching of shade, color or mottling.*
- 2. Any express or implied promise made by any salesman or representative.*
- 3. Tears, burns cuts or damage due to improper cleaning agents or maintenance methods.*
- 4. Sale of "Seconds", "Off Goods" or other irregular (non-first quality) flooring materials. With respect to "Seconds" or "Off Goods", such are sold "as is", and Johnsonite makes no warranties whatsoever, express or implied with respect thereto, including warranties of merchantability or fitness for a particular purpose.*
- 5. Problems caused by moisture, hydrostatic pressure, or alkali in the sub-floor.*
- 6. Problems caused by uses, maintenance and installation that are contrary to Johnsonite's specifications, recommendations or instructions.*
- 7. Material installed with obvious defects.*
- 8. Damage to flooring products caused by high heels or spike heels, improper floor protectors/casters and furniture rests.*
- 9. Installation of Johnsonite products with adhesives other than those recommended by Johnsonite.*
- 10. Exterior installations. Johnsonite's products are designed for interior applications only.*

CONT.

11. Damage to flooring products from pallet jack and tow motor traffic.
12. Differences in color between products, sample materials, color illustrations and photography.
13. Additional expenses associated with overtime, replacing appliances, moving furniture, business interruptions, loss of use or other related costs associated to the replacement of the flooring.

These warranties are in lieu of any other express or implied warranties. Johnsonite shall not be liable for any incidental or consequential damages which result from a defect or whether based on breach of express or implied warranty, negligence, strict liability or any other legal theory, except where the exclusion or limitation of incidental or consequential damages is prohibited by state law. These warranties give you specific legal rights and you may have other rights which may vary from state to state. To know what your legal rights are in your state, consult your local or state Consumer Affairs Office or your State Attorney General.

If you believe you have a claim under this warranty, please take the following steps:

1. Contact the flooring dealer who sold you the floor.
2. If corrective measures do not take place promptly and the problem is manufacturing related, contact:

*Erv Parent Group
5 Otter Street, Winnipeg, Manitoba R3T 0M7
Ph: 204-475-3555 Fax: 204-452-582*

Job Name: HORIZON – CITY OF BRANDON

Installer: JIENKINS - BRANDON

Products/yardage: OPTIMA – 1039 SY COLORS 861,873,874,875

INSTALLED: MAY 2014

Johnsonite®

iQ Natural, iQ Optima and iQ Granit

Maintenance Instructions for sheet and tile flooring

Initial Cleaning

Job site conditions usually cause grit and dirt to accumulate. Initial cleaning should not be performed until 5 days after installation. However the floor should be swept and protected until maintenance begins.

1. Thoroughly sweep or vacuum the flooring to remove all loose dirt and grit.
2. Prepare a cleaning solution of 2 to 4 oz of Taski "Profi" or Johnson Wax Professional "Stride" oil and grease emulsifying neutral detergents (pH of 7-8), per gallon of warm water. The dilution selected depends on light to heavy soil conditions.
3. Apply the cleaning solution with a nylon or rayon mop, and let stand for 5-15 minutes.
4. **IMPORTANT – do not let the solution dry.**
5. Scrub the flooring: Use a 22 gauge nylon bristle brush or low abrasive pad (tan or red) on a single disk rotary\scrubbing machine at low speed (150- 200 RPM).
6. Wet vacuum or mop-up the cleaning solution.
7. Rinse with clean cold water, and then remove all water by vacuum or mop. Replace rinse water often.
8. Allow the flooring to dry thoroughly (Approximately one hour, depending on temperature and humidity).
9. If trades continue to work on or over the floor, properly protect the floor from damage.

Preventative Care:

1. An effective barrier matting system should be installed at all entrances to reduce cleaning costs and extend the life of the floor.
2. Protect the flooring from damage by using good quality protective feet for chairs, tables, and other furniture. Chair mats may be required under chairs with casters/wheels.

Regular/Daily Cleaning:

It is very important to clean flooring at a frequency consistent with the amount and type of traffic. Daily cleaning is recommended.

1. Sweep, vacuum, or dry mop the floor daily when area is in use.
2. Damp mop the floor with a neutral cleaner\detergent (pH of 7-8) such as Taski's "Profi" or Johnson Wax Professional's "Stride Neutral".
 - Mix solution with water per manufacturer's directions.
 - The floor should not be flooded with water. The floor must be virtually dry after 15-20 seconds. Combine machine may be used in large areas. White or red pads should be used.
3. Remove minor stains and scuffs in conjunction with the cleaning. Use a white or red nylon pad with the neutral cleaner then wipe with clean water.

Dry buffing will produce a matte gloss patina finish.

- Initially buff daily for 30 days if possible, the floor will take on a matte gloss patina appearance that has

very good resistance to scuff and will require only minimum upkeep. The patina like appearance will become apparent after five or six buffing operations.

- After the desired gloss appearance has been achieved, buffing frequency can be reduced to fit the traffic pattern required.

Interim Cleaning:

Frequency of interim cleaning depends on the amount and type of traffic.

1. Follow the daily maintenance routine.
2. Additional cleaning requires the use of a rotary\scrubbing machine.
 - Mix neutral cleaner and water per manufacture's directions for spray application.
 - Spray the solution on the floor as the floor is cleaned with a low speed rotary\scrubbing machine (150-200 RPM) with a red fiber pad.
 - Rinse floor with clean water.

Combine machine may be used instead of a rotary\scrubbing machine. White or red pads should be used.

Periodic Cleaning:

Frequency of periodic cleaning depends on the amount and type of traffic

1. Repeat steps for Interim Cleaning.
2. For reduced Maintenance System: Finish process by dry buffing the floor with a red pad (Suitable speed – 1,500 RPM).

Flooring may be maintained in the conventional floor polish/finish maintenance system if desired. Conventional floor polish/finish maintenance system requires periodic stripping of the floor finish.

Special Maintenance Cautions:

1. Do not use steel wool, strong solvents (Lestoil, Top Job, etc. and similar products), gasoline, turpentine, and acetone.
2. Sweeping compounds or mop treated with petroleum solvents, silicone compounds or loose abrasives will damage the flooring.
3. Coatings such as shellac, lacquer, varnish, and paste wax or those containing aromatic solvents are not recommended.
4. Some disinfectant and insecticide sprays contain oil or solvents which may settle on the floor in sufficient quantity to discolor, cause slipperiness, and harm the floor covering.

Johnsonite®

Technical Services Department
16910 Munn Road, Chagrin Falls, Ohio 44023
(800) 899-8916 ext 297 Fax (440) 543-8920
www.johnsonite.com
E-mail: info@johnsonite.com
© 2012 Johnsonite, Inc. A Tarkett Company



Material Health and Safety Data Sheet

Optima 2.0

1. Company:

Tarkett AB, S-372 81 Ronneby, Sweden.

Phone. Int: +46-457-710 00, Fax. Int: +46-457-705 28, 710 20.

2. Composition:

Polymer - Plasticiser - Stabiliser - Filler - Pigment - Surface reinforcement.

There are no CAS no or CEE no for the product, as there is no class system fitting this product.

3. Hazard Identification:

No health hazard or symptoms.

4. First Aid Measures:

Not relevant.

5. Fire Fighting Measures:

The product is generally resistant to ignition.

Reaction to fire:

DIN 4102; B1.

BS 476: Part 7, 1997; Class 2.

EN ISO 13501-1; Class B_{fl} s1.

EN ISO 9239-1; ≥ 8 kW/m².

EN ISO 11925-2; pass.

a. Suitable Extinguishing Media - water, foam, carbon dioxide or dry powder.

b. Unsuitable Extinguishing Media - none.

c. Products Of Combustion - hydrochloric acid, carbon dioxide and carbon monoxide.

d. Risks for exposition to products of combustion - hydrochloric acid is corrosive and hazardous for inhalation.

e. Observe normal fire fighting procedures.

6. Accidental Release Measures:

No special measures are required.

7. Handling And Storage:

Prevent standing rolls for falling, to eliminate risk for personal accidents.

Store in original packaging in a dry place.

Weight of product 2.9 kg/m².

EN 426 Sheet (rolls). 1 roll approx. 25 running metres x 200 cm, = 50 m². Total weight of rolls 145 kg.

EN 427 Tiles. 61 x 61 cm, 14 tiles/box = 5.21 m².

Dual manual handling or mechanical lifting required.

8. Exposure Controls And Personal Protection:

No special requirement.

9. Physical And Chemical Properties:

Appearance - homogeneous vinyl floor covering (solid).

pH - not relevant.

Melting point/range - no melting point. Material softens, starting at + 60°C.

Flammability (solids) - not relevant.

Threshold limit of superior explosivity (%) - not relevant.

Explosive properties - not explosive.

Steam power (Pa) - not relevant.

Water solubility (g/dm³) - 0.0 g/m³.

Partition factor (n-octane/water) (log P) - not relevant.

Miscibility (g/dm³) - not relevant.

Conductivity (S) - not relevant.

Solubility in organic (specify solvent and quantity) - insoluble in water and chemically inert.

Smelling - no.

Boiling point/range (°C) - not relevant.

Point of flammability (°C) - not relevant (see item 5).

Self flammability (°C) - not relevant (see item 5).

Threshold limit of inferior explosivity (%) - not relevant.

Burning properties - see item 5.

Relative density - 1.45 kg/dm³.

Liposolubility (mg/100g) - not relevant.

Steam density (g/cm³) - not relevant.

Speed of evaporation (g/s) - not relevant.

Viscosity (mPa x s) - not relevant.

Volatile substances (% mass) - 0.0.

10. Stability And Reactivity:

No special physical conditions need to be avoided.

11. Toxicological Effects:

No known toxicological effects.

12. Ecological Information:

Stable product with no known adverse environmental effects.

13. Disposal considerations:

No special precautions. According to legislation.

14. Transport Information:

No special precautions. Information as item 7.

15. Regulatory Information:

No special labelling required.

16. Other Information:

Vinyl floor coverings are not classified as chemical products and are not under the obligation to render an account. This information is on voluntary basis and reflects only the relevant information.

Further information about Optima can be found in Optima data sheet and from Tarkett AB, S-372 81 Ronneby, Sweden.

Phone. Int: +46-457-710 00, Fax. Int. +46-457-705 28, 710 20.

MAINTENANCE GUIDELINES

When performing any wet maintenance, always use wet floor signs.

Newly Installed Floor Care

- Keep all foot traffic off the new floor for 12 hours. When using S150 Spray Adhesive, material can be walked on immediately.
- Keep furniture, fixtures and rolling traffic off the new floor for 36 hours when using Shaw 4100; when using S150 Spray, avoid rolling traffic for 24 hours.
- Remove adhesive residue with a clean white cloth dampened with mineral spirits.
- Use 1/4" or thicker plywood to protect the surface when moving heavy objects across the new floor.
- Lightly damp mop the floor as needed.
- Wait 4 days before wet washing and scrubbing the new floor.

Initial Maintenance

- Sweep, vacuum or dust mop to remove dirt and grit.
- If needed, add neutral cleaner to cool water following the manufacturer's instructions.
- Scrub with a low-rpm machine or auto scrubber. Use a red pad or brush.
- Never use brown or black pads (too aggressive and can damage the product).
- Remove the cleaning solution with a wet-dry vacuum or auto scrubber until the floor is dry.
- Rinse the floor with clean water. Repeat the rinse process if necessary to remove all haze.

Routine Maintenance

- Sweep, vacuum or dust mop to remove dirt and grit.
- Add neutral pH cleaner to cool water following the manufacturer's instructions.
- As needed, scrub with a low-rpm machine or auto scrubber to retain appearance. Use a red (light scrubbing) pad and neutral cleaner following the manufacturer's instructions.

Preventative Floor Care

- Use walk-off mats that are as wide as the doorway and long enough for soil load and weather conditions.
- Use mats with a non-staining backing.
- Floor protectors should be used on all furniture legs.
- The surface area of the floor protectors should be no less than 1" in diameter.

For a list of recommended maintenance products contact Shaw Inforum: 1-877-502-7429

Product Specifications

Style Name	Crete
Style Number	0203V
Construction	High Performance Luxury Vinyl Tile
Class / ASTM F 1700	Class III Printed Film Vinyl Tile, Type A (smooth), Type B (embossed)
Wearlayer Thickness	20 mil or 0.020" (0.5 mm)
Overall Thickness	3 mm or nominal 0.125"
Nominal Dimensions	18" wide x 18" long
Actual Size / ASTM F 536	Width: 17.72" or 450 mm, Length: 17.72" or 450 mm
Finish	ExoGuard™ Quartz-Enhanced Urethane
Backing Class	Commercial Grade
Installation	Glue Down
Recommended Adhesive	Shaw 4100 or S150

Packaging

Square Feet per Carton	34.88 sf
Pieces per Carton	16 pcs
Weight per Carton	37.84 lbs

Testing

Slip Resistance / ASTM D 2047	>0.65 (wet/dry)
Static Load Limit / (modified) ASTM F 970	1500 psi
Flexibility / ASTM F 137	Passes
Resistance to Heat / ASTM F 1514	Passes
Resistance to Light / ASTM F 1515	Passes
Resistance to Chemicals / ASTM F 925	Passes
Radiant Flux / ASTM 648	Passes, >0.45 watts/cm ² , NFPA Class I
Smoke Density / ASTM E 662	Passes, <450

Warranty

10 year limited commercial wear warranty. 10 year under bed warranty when installed with Shaw 4100 or Shaw S150 spray adhesive. Please visit www.shawhardsurface.com for the most current warranty information.

Environmental

Recycled Content	Post-consumer – 0% Pre-consumer – 0%
Indoor Air Quality	FloorScore® certified
LEED Scorecard	EQ4.1, EQ4.3



Specifications are subject to nominal manufacturing variance.

Material supply and/or manufacturing processes may necessitate changes without notice.



Attn:
Harry

Section 09.65.19.33

**RESILIENT TILE FLOORING INCLUDING
MESTO, MESTO CONFIGURATIONS, MICROTONE, AND PRIMA
RUBBER FLOOR TILE**

THIS DOCUMENT IS INTENDED AS A SUGGESTED GUIDE FOR CREATING, MODIFYING, OR EDITING YOUR CSI FORMATTED 3-PART ARCHITECTURAL GUIDE SPECIFICATIONS.

JOHNSONITE WILL NOT BE LIABLE FOR ANY DAMAGES ARISING OUT OF THE USE OF ANY INFORMATION OR SPECIFICATIONS FOUND IN THIS DOCUMENT.

ENSURE THAT YOU HAVE THE LATEST PUBLICATION FOR THIS SPECIFICATION.

THE SPECIFIER OR DESIGNER IS RESPONSIBLE FOR PRODUCT SELECTION AND ACCURACY OF ALL PROJECT SPECIFICATIONS, INCLUDING ANY JOHNSONITE INFORMATION OR SPECIFICATIONS USED.

PART 1 - GENERAL

1.1 RELATED DOCUMENTS

- A. Drawings and general provisions of the Contract, including General and Supplementary Conditions and Division 01 Specification Sections, apply to this Section.

1.2 SUMMARY

- A. Section Includes:
 - 1. Resilient Rubber Tile Flooring.

1.3 SUBMITTALS

- A. Product Data: For each type of product indicated.
- B. LEED Submittals:
 - 1. Product Data for Credit EQ 4.1: For adhesives, include printed statement of VOC content and chemical components.

Section 09.65.19.33**RESILIENT TILE FLOORING INCLUDING
MESTO, MESTO CONFIGURATIONS, MICROTONE, AND PRIMA
RUBBER FLOOR TILE**

- C. Samples for Initial Selection: For each type of product indicated.
- D. Samples for Verification: For each type of product indicated, in manufacturer's standard-size samples of each resilient product color, texture, and pattern required.
- E. Product Schedule: For resilient products. Use same designations indicated on Drawings.

1.4 QUALITY ASSURANCE

- A. Mockups: Provide resilient products with mockups specified in other Sections.

1.5 DELIVERY, STORAGE, AND HANDLING

- A. Store resilient products and installation materials in dry spaces protected from the weather, with ambient temperatures maintained within range recommended by Johnsonite, but not less than 55 deg F (13 deg C) or more than 85 deg F (29 deg C).

1.6 PROJECT CONDITIONS

- A. Install resilient products after other finishing operations, including painting, have been completed.
- B. Maintain ambient temperatures within range recommended by Johnsonite, but not less than 65 deg F (18 deg C) or more than 85 deg F (29 deg C) in spaces to receive resilient products during the following time periods:
 - 1. 48 hours before installation.
 - 2. During installation.
 - 3. 48 hours after installation.
- C. Maintain the ambient relative humidity between 40% and 60% during installation.
- D. Until Substantial Completion, maintain ambient temperatures within range recommended by Johnsonite, but not less than 55 deg F (13 deg C) or more than 85 deg F (29 deg C).

Section 09.65.19.33

**RESILIENT TILE FLOORING INCLUDING
MESTO, MESTO CONFIGURATIONS, MICROTONE, AND PRIMA
RUBBER FLOOR TILE**

PART 2 - PRODUCTS**2.1 RESILIENT TILE FLOORING****Manufacturer:**

Johnsonite, Inc.

Phone: (800) 899-8916

16910 Munn Road

(440) 543-8916

Chagrin Falls, Ohio 44023

Tech: Ext 9297

Web: www.tarketna.com

Samples: Ext 9299

E-mail: info@johnsonite.com

Fax: (440) 543-8920

ENVIRONMENTAL SUSTAINABILITY NOTES:**Johnsonite Mesto, Mesto Configurations, Microtone, and Prima Rubber Tile**

- Johnsonite offers a RESTART reclamation program for returning jobsite scrap
- SCS FloorScore® Certified and meets California Specifications Section 01350
- Phthalate-free; chlorine-free and halogen-free
- NSF-332 Gold Certified
- Johnsonite facilities are ISO 9001 and ISO 14001 Certified
- Possible LEED contributions for Johnsonite Mesto, Mesto Configurations, Microtone and Prima Rubber Flooring include MR2; MR5; and EQ4.3
- For all environmental sustainability information visit ecoScorecard on Johnsonite home page at www.tarketna.com

A. Resilient Rubber Tile Flooring**1. MESTO and MESTO CONFIGURATIONS Rubber Tile specify – Resilient Rubber Tile Flooring with the following physical characteristics:**

- a. Complies with requirements for ASTM F 1344 Standard Specification for Rubber Floor Tile, Class 1-A and 1-B.
- b. Manufactured from a homogeneous composition of 100% synthetic rubber
- c. Overall thickness: .080" (2.0 mm).
- d. Hammered texture tile tones:
 - 1) Mesto.
 - 2) Mesto (Light Version).
 - 3) Mesto (Dark Version).
- e. Hammered texture tile size:

Section 09.65.19.33

RESILIENT TILE FLOORING INCLUDING MESTO, MESTO CONFIGURATIONS, MICROTONE, AND PRIMA RUBBER FLOOR TILE

- 1) Mesto.
 - a) 12" x 12" (30.5 cm x 30.5 cm).
 - 2) Mesto Configurations
 - a) 6" x 6" (15.2 cm x 15.2 cm).
 - b) 12" x 12" (30.5 cm x 30.5 cm).
 - c) 6" x 24" (15.2 cm x 61 cm).
 - d) 12" x 24" (30.5 cm x 61 cm).
 - f. ASTM D 2240 Standard Test Method for Rubber Property—Durometer Hardness: 65 Shore A.
 - g. ASTM D 3389 Standard Test Method for Coated Fabrics Abrasion Resistance: < 1.00 gram weight loss.
 - h. ASTM D 2047, Standard Test Method for Static Coefficient of Friction of Polish-Coated Flooring: Exceeds Federal Standards and A.D.A. requirements for slip-resistant.
 - i. ASTM F 970, Standard Test Method for Static Load Limit – passes at 250 PSI.
 - j. ASTM E 648, Standard Test method for Critical Radiant Flux of Floor-Covering Systems Using a Radiant Heat Energy Source – equal to or greater than 0.45 watts/cm².
 - k. Johnsonite offers a RESTART reclamation program for returning jobsite scrap.
 - l. SCS FloorScore® Certified and meets California Specifications Section 01350.
 - m. Phthalate, chlorine and halogen-free.
 - n. NSF-332 Gold Certified.
 - o. Johnsonite facilities are ISO 9001 and ISO 14001 Certified.
 - p. Possible LEED contributions for Johnsonite Mesto, and Mesto Configurations Rubber Flooring include MR2; MR5; and EQ4.3.
- For MESTO specify (MHO ____ [specify color by number and name] ____ [specify 12" x 12" size])
 - For MESTO CONFIGURATIONS specify (MHO ____ [specify color by number and name(specify L for light tone or D for darker tone)] ____ [specify size])
2. MICROTONE Hammered Texture Speckled Rubber Tile specify – Resilient Rubber Tile Flooring with the following physical characteristics:
 - a. Complies with requirements for ASTM F 1344 Standard Specification for Rubber Floor Tile, Class 1-B.
 - b. Manufactured from a homogeneous composition of 100% synthetic rubber.
 - c. Overall thickness: .080" (2.0 mm) and .125".
 - d. Tile size: 24" x 24" (61 cm x 61 cm).
 - e. ASTM D 2240 Standard Test Method for Rubber Property—Durometer Hardness: Not less than 85 Shore A.
 - f. ASTM D 3389 Standard Test Method for Coated Fabrics Abrasion Resistance: < 1.00 gram weight loss.

Section 09.65.19.33

RESILIENT TILE FLOORING INCLUDING MESTO, MESTO CONFIGURATIONS, MICROTONE, AND PRIMA RUBBER FLOOR TILE

- g. ASTM D 2047, Standard Test Method for Static Coefficient of Friction of Polish-Coated Flooring: Exceeds Federal Standards and A.D.A. requirements for slip-resistant.
- h. ASTM F 970, Standard Test Method for Static Load Limit – passes at 250 PSI.
- i. ASTM E 648, Standard Test method for Critical Radiant Flux of Floor-Covering Systems Using a Radiant Heat Energy Source – Class 1.
- j. Johnsonite offers a RESTART reclamation program for returning jobsite scrap.
- k. SCS FloorScore® Certified and meets California Specifications Section 01250.
- l. Phthalate, chlorine and halogen free.
- m. NSF-332 Gold Certified.
- n. Johnsonite facilities are ISO 9001 and ISO 14001 Certified.
- o. Possible LEED contributions for Johnsonite Microtone Rubber Flooring include MR2; MR5; and EQ4.3.

- For MICROTONE RUBBER FLOOR TILE specify:

HNSP XX – Hammered Surface Rubber Floor Tile, specify 0.080" (2 mm) thickness, 24" x 24" (61 cm x 61 cm)

HRTSP XX – Hammered Surface Rubber Floor Tile, specify 0.125" (3.17 mm) thickness, 24" x 24" (61 cm x 61 cm)

FRPANSP XX – Rice Paper Surface Pattern Rubber Tile, specify 0.080" (2 mm) thickness, 24" x 24" (61 cm x 61 cm)

FRPASP XX – Rice Paper Surface Pattern Rubber Tile, specify 0.125" (3.17 mm) thickness, 24" x 24" (61 cm x 61 cm)

RTSP XX RD – Raised Round Disk Pattern Rubber Tile, specify 0.125" (3.17 mm) thickness, 24" x 24" (61 cm x 61 cm)

RTSP XX SQ – Raised Square Disk Pattern Rubber Tile, specify 0.125" (3.17 mm) thickness, 24" x 24" (61 cm x 61 cm)

BMRTSP XX – Bamboo Surface Pattern Rubber Tile, specify 0.125" (3.17 mm) thickness, 24" x 24" (61 cm x 61 cm)

CNSP XX – Diamond Surface Pattern Rubber Tile, specify 0.125" (3.17 mm) thickness, 24" x 24" (61 cm x 61 cm)

3. SMOOTH or RAISED SURFACE Rubber Tile specify – Resilient Rubber Tile Flooring with the following physical characteristics:
 - a. Complies with requirements for ASTM F 1344 Standard Specification for Rubber Floor Tile, Class 1-A and 1-B.

Section 09.65.19.33

**RESILIENT TILE FLOORING INCLUDING
MESTO, MESTO CONFIGURATIONS, MICROTONE, AND PRIMA
RUBBER FLOOR TILE**

- b. Manufactured from a homogeneous composition of 100% synthetic rubber.
 - c. Disk Height for Raised Round or Raised Square specify: .025".
 - d. Overall thickness:
 - 1) For Smooth Surface specify: .100" (2.54 mm) or .130" (3.30 mm) or [.125" (3.18 mm) for Landing Tiles only].
 - 2) For Raised Round or Raised Square Surface specify: 1/8" [.125" (3.17 mm)] or .155 (4mm).
 - e. Tile size: 24" x 24" (61 cm x 61 cm).
 - f. ASTM D 2240 Standard Test Method for Rubber Property—Durometer Hardness: 65 Shore A.
 - g. ASTM D 3389 Standard Test Method for Coated Fabrics Abrasion Resistance: < 1.00 gram weight loss.
 - h. ASTM D 2047, Standard Test Method for Static Coefficient of Friction of Polish-Coated Flooring: Exceeds Federal Standards and A.D.A. requirements for slip-resistant.
 - i. ASTM F 970, Standard Test Method for Static Load Limit – passes at 250 PSI.
 - j. ASTM E 989, Standard Classification for Rating Impact Insulation (IIC) using ASTM E 492, Acoustical Measurement of Impact Sound Transmission Through Floor-Ceiling Assemblies Using the Tapping Machine – 40 IIC.
 - k. ASTM E 648, Standard Test method for Critical Radiant Flux of Floor-Covering Systems Using a Radiant Heat Energy Source – equal to or greater than 0.45 watts/cm².
 - l. Johnsonite offers a RESTART reclamation program for returning jobsite scrap.
 - m. SCS FloorScore® Certified and meets California Specifications Section 01350.
 - n. Phthalate, chlorine and halogen free.
 - o. NSF-332 Gold Certified.
 - p. Johnsonite facilities are ISO 9001 and ISO 14001 Certified.
 - q. Possible LEED contributions for Johnsonite Rubber Flooring include MR2; MR5; and EQ4.3.
- For SMOOTH ACCENT SOLID COLOR Tile specify (RET ____ [specify color by name and number] ____ [specify thickness { .100" (2.54 mm) or .130" (3.30 mm) }])
 - For SMOOTH SURFACE SOLID COLOR Tile specify (C ____ [specify color by name and number] ____ [specify thickness { .125" (3.18 mm) for Landing Tiles only }])
 - For RAISED ROUND SOLID COLOR Tile specify (RT ____ [specify color by number and name] ____ [specify thickness] – RD)
 - For RAISED ROUND SPECKLED COLOR Tile specify (RTSP ____ [specify color by number and name] ____ [specify thickness] – RD)
 - For RAISED SQUARE SOLID COLOR Tile specify (RT ____ [specify color by number and name] ____ [specify thickness] – SQ)
 - For RAISED SQUARE SPECKLED COLOR Tile specify (RTSP ____ [specify color by number and name] ____ [specify thickness] – SQ)

Section 09.65.19.33**RESILIENT TILE FLOORING INCLUDING
MESTO, MESTO CONFIGURATIONS, MICROTONE, AND PRIMA
RUBBER FLOOR TILE**

4. TEXTURED SURFACE Rubber Tile specify ~ Resilient Rubber Tile Flooring with the following physical characteristics:
 - a. Complies with requirements for ASTM F 1344 Standard Specification for Rubber Floor Tile, Class 1-A and 1-B.
 - b. Manufactured from a homogeneous composition of 100% synthetic rubber.
 - c. Overall thickness: 1/8" [.125" (3.17 mm)].
 - d. Tile Size:
 - 1) For Solid Color or Speckled Color Tile specify 24" x 24" (61 cm x 61 cm).
 - 2) For Marbleized Prima Custom and Ohio Color Tile specify 12" x 12" (30.5 cm x 30.5 cm).
 - e. Tile Textures:
 - 1) Artistic Square.
 - 2) Bamboo.
 - 3) Chopped Bamboo.
 - 4) Cubis.
 - 5) Flagstone.
 - 6) Hammered.
 - 7) Pebbles.
 - 8) Rice Paper.
 - 9) Weathered.
 - 10) Circularity:
 - a) Effervescent.
 - b) Fast Lane.
 - c) Round-A-Bout.
 - d) Tic-Tac-Toe.
 - e) Tricycle.
 - 11) Folio:
 - a) Arbor.
 - b) Bamboo Leaf.
 - c) Botany.
 - d) Branches.
 - e) River Cane.
 - f) Seasons.
 - f. ASTM D 2240 Standard Test Method for Rubber Property—Durometer Hardness: 65 Shore A.
 - g. ASTM D 3389 Standard Test Method for Coated Fabrics Abrasion Resistance: < 1.00 gram weight loss.
 - h. ASTM D 2047, Standard Test Method for Static Coefficient of Friction of Polish-Coated Flooring: Exceeds Federal Standards and A.D.A. requirements for slip-resistant.
 - i. ASTM F 970, Standard Test Method for Static Load Limit – passes at 250 PSI.

Section 09.65.19.33

**RESILIENT TILE FLOORING INCLUDING
MESTO, MESTO CONFIGURATIONS, MICROTONE, AND PRIMA
RUBBER FLOOR TILE**

- j. ASTM E 989, Standard Classification for Rating Impact Insulation (IIC) using ASTM E 492, Acoustical Measurement of Impact Sound Transmission Through Floor-Ceiling Assemblies Using the Tapping Machine – 40 IIC.
- k. ASTM E 648, Standard Test method for Critical Radiant Flux of Floor-Covering Systems Using a Radiant Heat Energy Source – equal to or greater than 0.45 watts/cm².
- l. Johnsonite offers a RESTART reclamation program for returning jobsite scrap.
- m. SCS FloorScore® Certified and meets California Specifications Section 01350.
- n. Phthalate, chlorine and halogen-free.
- o. NSF-332 Gold Certified.
- p. Johnsonite facilities are ISO 9001 and ISO 14001 Certified.
- q. Possible LEED contributions for Johnsonite rubber flooring include MR2; MR5; and EQ4.3.

- For ARTISTIC SQUARE SOLID COLOR specify (ARTS ____ [specify color by number and name] ____ [specify size] ____ [specify thickness])
- For ARTISTIC SQUARE SPECKLED COLOR specify (ARTSP ____ [specify color by number and name] ____ [specify size] ____ [specify thickness])
- For BAMBOO SOLID COLOR specify (BMRTS ____ [specify color by number and name] ____ [specify size] ____ [specify thickness])
- For BAMBOO SPECKLED COLOR specify (BMRTSP ____ [specify color by number and name] ____ [specify size] ____ [specify thickness])
- For CHOPPED BAMBOO SOLID COLOR specify [CBMRTS ____ (specify color by number and name] ____ [specify size] ____ [specify thickness])
- For CHOPPED BAMBOO SPECKLED COLOR specify [CBMRTSP ____ (specify color by number and name] ____ [specify size] ____ [specify thickness])
- For CUBIS SOLID COLOR specify (CRTS ____ [specify color by number and name] ____ [specify size] ____ [specify thickness])
- For CUBIS SPECKLED COLOR specify (CRTSP ____ [specify color by number and name] ____ [specify size] ____ [specify thickness])
- For FLAGSTONE SOLID COLOR specify (FRTS ____ [specify color by number and name] ____ [specify size] ____ [specify thickness])
- FOR FLAGSTONE SPECKLED COLOR specify (FRTSP ____ [specify color by number and name] ____ [specify size] ____ [specify thickness])
- For HAMMERED SOLID COLOR specify (HRTS ____ [specify color by number and name] ____ [specify size] ____ [specify thickness])
- For HAMMERED SPECKLED COLOR specify (HRTSP ____ [specify color by number and name] ____ [specify size] ____ [specify thickness])

Section 09.65.19.33

**RESILIENT TILE FLOORING INCLUDING
MESTO, MESTO CONFIGURATIONS, MICROTONE, AND PRIMA
RUBBER FLOOR TILE**

- For PEBBLES SOLID COLOR specify (PRTS ____ [specify color by number and name] ____ [specify size] ____ [specify thickness])
 - For PEBBLES SPECKLED COLOR specify (PRTSP ____ [specify color by number and name] ____ [specify size] ____ [specify thickness])
 - For RICE PAPER SOLID COLOR specify (FRPA ____ [specify color by number and name])
 - For WEATHERED SOLID COLOR specify (WRTS ____ [specify color by number and name] ____ [specify size] ____ [specify thickness])
 - For WEATHERED SPECKLED COLOR specify (WRTSP ____ [specify color by number and name] ____ [specify size] ____ [specify thickness])
 - For CIRCULINITY EFFERVESCENT SOLID COLOR specify (CEF ____ [specify color by number and name])
 - For CIRCULINITY FAST LANE SOLID COLOR specify (CFL ____ [specify color by number and name])
 - For CIRCULINITY ROUND-A-BOUT SOLID COLOR specify (CRB ____ [specify color by number and name])
 - For CIRCULINITY TIC-TAC-TOE SOLID COLOR specify (CTT ____ [specify color by number and name])
 - For CIRCULINITY TRICYCLE SOLID COLOR specify (CTR ____ [specify color by number and name])
 - For FOLIO ARBOR SOLID COLOR specify (FARB ____ [specify color by number and name])
 - FOR FOLIO BAMBOO LEAF SOLID COLOR specify (FBLF ____ [specify color by number and name])
 - For FOLIO BOTANY SOLID COLOR specify (FBOT ____ [specify color by number and name])
 - For FOLIO BRANCHES SOLID COLOR specify (FBRN ____ [specify color by number and name])
 - For FOLIO RIVER CANE SOLID COLOR specify (FRCN ____ [specify color by number and name])
 - For FOLIO SEASONS SOLID COLOR specify (FSEA ____ [specify color by number and name])
5. PRIMA OLIO and PRIMA MARBLEIZED Tile specify – Resilient Rubber Tile Flooring with the following physical characteristics:
- a. Complies with requirements for ASTM F 1344 Standard Specification for Rubber Floor Tile, Class 1-A and 1-B.
 - b. Manufactured from a homogeneous composition of 100% synthetic rubber.

Section 09.65.19.33

**RESILIENT TILE FLOORING INCLUDING
MESTO, MESTO CONFIGURATIONS, MICROTONE, AND PRIMA
RUBBER FLOOR TILE**

- c. Overall thickness: 1/8" [.125" (3.17 mm)].
 - d. Tile size: 12" x 12" (30.5 cm x 30.5 cm).
 - e. Tile Textures:
 - 1) Smooth.
 - 2) Flagstone.
 - 3) Hammered.
 - 4) Weathered.
 - f. ASTM D 2240 Standard Test Method for Rubber Property—Durometer Hardness: 65 Shore A.
 - g. ASTM D 3389 Standard Test Method for Coated Fabrics Abrasion Resistance: < 1.00 gram weight loss.
 - h. ASTM D 2047, Standard Test Method for Static Coefficient of Friction of Polish-Coated Flooring: Exceeds Federal Standards and A.D.A. requirements for slip-resistant.
 - i. ASTM F 970, Standard Test Method for Static Load Limit – passes at 250 PSI.
 - j. ASTM E 989, Standard Classification for Rating Impact Insulation (IIC) using ASTM E 492, Acoustical Measurement of Impact Sound Transmission Through Floor-Ceiling Assemblies Using the Tapping Machine – 40 IIC.
 - k. ASTM E 648, Standard Test method for Critical Radiant Flux of Floor-Covering Systems Using a Radiant Heat Energy Source – equal to or greater than 0.45 watts/cm².
 - l. Johnsonite offers a RESTART reclamation program for returning jobsite scrap.
 - m. SCS FloorScore® Certified and meets California Specifications Section 01350.
 - n. Phthalate, chlorine and halogen-free.
 - o. NSF-332 Gold Certified.
 - p. Johnsonite facilities are ISO 9001 and ISO 14001 Certified.
 - q. Possible LEED contributions for Johnsonite Prima rubber flooring include MR2; MR5; and EQ4.3.
- For SMOOTH PRIMA COLOR specify (PRIMA ____ [specify by color number and name])
 - For SMOOTH OLIO COLOR specify (OLIO SMOOTH ____ [specify by color number and name])
 - For FLAGSTONE PRIMA COLOR specify (FRTP ____ [specify by color number and name])
 - For FLAGSTONE OLIO COLOR specify (FRTP ____ [specify by color number and name])
 - For HAMMERED PRIMA COLOR specify (HRTTP ____ [specify by color number and name])
 - For HAMMERED OLIO COLOR specify (HRTPO ____ [specify by color number and name])

Section 09.65.19.33**RESILIENT TILE FLOORING INCLUDING
MESTO, MESTO CONFIGURATIONS, MICROTONE, AND PRIMA
RUBBER FLOOR TILE**

- For WEATHERED PRIMA COLOR specify (WRTP ____ [specify by color number and name])
- For WEATHERED OLIO COLOR specify (WRTPO ____ [specify by color number and name])

2.2 INSTALLATION MATERIALS

- A. Trowelable Leveling and Patching Compounds: Latex-modified, Portland cement based or blended hydraulic-cement-based formulation.
- B. Adhesives: As recommended by Johnsonite to meet site conditions.
 - 1. Rubber Floor Tile
 - a. Johnsonite #965 Flooring and Tread Adhesive
 - b. Johnsonite #975 Two-Part Urethane Adhesive
 - c. Johnsonite #996 Two-Part Epoxy Adhesive
 - d. Johnsonite 140 SpraySmart Adhesive

PART 3 - EXECUTION**3.1 EXAMINATION**

- A. Examine substrates, with Installer present, for compliance with requirements for maximum moisture content and other conditions affecting performance of the work.
- B. Verify that finishes of substrates comply with tolerances and other requirements specified in other Sections and that substrates are free of cracks, ridges, depressions, scale, and foreign deposits that might interfere with adhesion of resilient products.
- C. Proceed with installation only after unsatisfactory conditions have been corrected.

3.2 PREPARATION

- A. Prepare substrates according to Johnsonite written instructions to ensure adhesion of Resilient Tile Flooring.
 - 1. Verify that substrates are dry and free of curing compounds, sealers, and hardeners.
 - 2. Remove substrate paint, coatings and other substances that are incompatible with adhesives or contain soap, wax, oil, solvents, or silicone, using mechanical methods recommended by manufacturer. Do not use solvents.
 - 3. Mechanically remove contamination on the substrate that may cause damage to the resilient flooring material. Permanent and non-permanent markers, pens, crayons, paint,

Section 09.65.19.33

**RESILIENT TILE FLOORING INCLUDING
MESTO, MESTO CONFIGURATIONS, MICROTONE, AND PRIMA
RUBBER FLOOR TILE**

etc., must not be used to write on the back of the flooring material or used to mark the substrate as they could bleed through and stain the flooring material.

4. Prepare Substrates according to ASTM F 710 including the following:
 - a. Moisture Testing: Perform tests recommended by manufacturer. Proceed with installation only after substrates pass testing.
 - 1) Perform anhydrous calcium chloride test, ASTM F 1869. Results must not exceed 5 lbs. Moisture Vapor Emission Rate per 1,000 sq. ft. in 24 hours.
 - or -
 - 2) Perform relative humidity test using in situ probes, ASTM F 2170. Must not exceed 80%.
 - b. A pH test for alkalinity must be conducted. Results should range between 7 and 9. If the test results are not within the acceptable range of 7 to 9, the installation must not proceed until the problem has been corrected.
 - c. Alkalinity and Adhesion Testing: Perform tests recommended by manufacturer.
5. Wood subfloors must have a minimum 18" (45.7 cm) of cross-ventilated space beneath the bottom of the joist.
 - a. The floor must be rigid, free of movement.
 - b. Single wood and tongue and groove subfloors should be covered with ¼" (6.4 mm) or ½" (12.7 mm) APA approved underlayment plywood.
 - 1) Use ¼" (6.4 mm) thick underlayment panels for boards with a face width of 3" (76 mm) or less.
 - 2) Use ½" (12.7 mm) thick underlayment panels for boards with a face width wider than 3" (76 mm).
 - c. Do not install over OSB (Oriented Strand Board), particle board, chipboard, lauan or composite type underlayments.

B. Fill cracks, holes, depressions and irregularities in the substrate with good quality Portland cement based underlayment leveling and patching compound and remove bumps and ridges to produce a uniform and smooth substrate.

C. Floor covering shall not be installed over expansion joints.

D. Do not install resilient products until they are same temperature as the space where they are to be installed.

1. Move resilient products and installation materials into spaces where they will be installed at least 48 hours in advance of installation.

E. Sweep and vacuum clean substrates to be covered by resilient products immediately before installation.

3.3 RESILIENT TILE FLOORING INSTALLATION

- A. Comply with manufacturer's written instructions for installing resilient tile flooring.

Section 09.65.19.33**RESILIENT TILE FLOORING INCLUDING
MESTO, MESTO CONFIGURATIONS, MICROTONE, AND PRIMA
RUBBER FLOOR TILE**

- B. Resilient Rubber Floor Tile:
 - 1. Install with Johnsonite adhesive specified for the site conditions and follow adhesive label for proper use.
 - 2. Do not Quarter Turn tile.
 - 3. Roll the flooring in both directions using a 100 pound three-section roller.
- 3.4 CLEANING AND PROTECTION
 - A. Comply with manufacturer's written instructions for cleaning and protection of resilient products.
 - B. Perform the following operations immediately after completing resilient product installation:
 - 1. Remove adhesive and other blemishes from exposed surfaces.
 - 2. Sweep and vacuum surfaces thoroughly.
 - 3. Damp-mop surfaces to remove marks and soil.
 - C. Protect resilient products from mars, marks, indentations, and other damage from construction operations and placement of equipment and fixtures during remainder of construction period.
 - D. No traffic for 24 hours after installation.
 - E. No heavy traffic, rolling loads, or furniture placement for 72 hours after installation.
 - F. Wait 72 hours after installation before performing initial cleaning.
 - G. A regular maintenance program must be started after the initial cleaning.

END OF SECTION 09.65.19



THE ULTIMATE
FLOORING EXPERIENCE

Product Specification

096519 RESILIENT TILE FLOORING

RUBBER STAIR TREADS

1. PROPRIETARY PRODUCT/MANUFACTURER

1.1. **Proprietary Product:** Resilient Rubber Stair Treads A.D.A., Visually-Impaired, and California Title 24 Compliant

1.2. Manufacturer:

Johnsonite, Inc.	Phone	(800) 899-8916
16910 Munn Road		(440) 543-8916
Chagrin Falls, Ohio 44023	Tech:	Ext 9297
Web: www.johnsonite.com	Samples:	Ext 9299
Email:	Fax:	(440) 543-8920
info@johnsonite.com		

1.3. Proprietary Product Description:

1.3.1. **Construction:** Johnsonite Rubber Stair Treads are manufactured from a homogeneous composition of 100% synthetic rubber, high quality additives, and colorants to meet the performance requirements of ASTM F-2169 Standard Specification for Resilient Stair Treads, Type TS, Class 1 and 2, Group 1 and 2. All Johnsonite Stair Treads are available with a 2" (5.08 cm) wide strip of contrasting color to comply with A.D.A., Visually-Impaired, and California Title 24 requirements. Standard formulation exceeds ASTM E 648 Class 1 Flammability requirements.

Johnsonite Rubber Stair Treads are designed for interior applications only and not recommended for environments where the product will be exposed to animal fats, vegetable oils, or petroleum based materials. (i.e.: commercial kitchens)

1.3.2. Styles:

- **RTR-RD & VIRTR-RD** (Visually Impaired) - Roundel Round Raised Disk Pattern Rubber Stair Tread with Integrated Riser, 20" (51 cm) overall length, 2" (5.08 cm) hinged, square nose configuration, .210" (5.33 mm) to .153" (3.89 mm) tapered 13" (33 cm) tread depth with 7" (17.8 cm) integral riser
 - VIRTR-RD with 2" (5.0 cm) wide contrasting color grit tape insert
 - VIRTRS-RD with 2" (5.0 cm) wide contrasting solid rubber color insert strip
 - VIRTRP-RD with 2" (5.0 cm) wide contrasting marbled rubber color insert strip
- **RTR-SQ & VIRTR-SQ** (Visually Impaired) - Roundel Square Raised Disk Pattern Rubber Stair Treads with Integrated Riser, 2" (5.08 cm) hinged, square nose configuration, .210" (5.33 mm) to .153" (3.89 mm) tapered 13" (33 cm) tread depth with 7" (17.8 cm) integral riser
 - VIRTR-SQ with 2" (5.0 cm) wide contrasting color grit tape insert
 - VIRTRS-SQ with 2" (5.0 cm) wide contrasting solid rubber color insert strip
 - VIRTRP-SQ with 2" (5.0 cm) wide contrasting

marbled rubber color insert strip

- **HTR & VIHTR** (Visually Impaired) - Hammered Surface Texture Rubber Stair Tread with Integrated Riser, 2" (5.08 cm) hinged, square nose configuration, .210" (5.33 mm) to .153" (3.89 mm) tapered 13" (33 cm) tread depth with 7" (17.8 cm) integral riser
 - VIHTR with 2" (5.0 cm) wide contrasting color grit tape insert
 - VIHTRS with 2" (5.0 cm) wide contrasting solid rubber color insert strip
 - VIHTRP with 2" (5.0 cm) wide contrasting marbled rubber color insert strip
- **BMTR & VIBMTR** (Visually Impaired) - Bamboo Surface Texture Rubber Stair Tread with Integrated Riser, 2" (5.08 cm) hinged, square nose configuration, .210" (5.33 mm) to .153" (3.89 mm) tapered 13" (33 cm) tread depth with 7" (17.8 cm) integral riser
 - VIBMTR with 2" (5.0 cm) wide contrasting color grit tape insert
 - VIBMTRS with 2" (5.0 cm) wide contrasting solid rubber color insert strip
 - VIBMTRP with 2" (5.0 cm) wide contrasting marbled rubber color insert strip
- **CUTR & VICUTR** (Visually Impaired) - Cubic Surface Texture Rubber Stair Tread with Integrated Riser, 2" (5.08 cm) hinged, square nose configuration, .210" (5.33 mm) to .153" (3.89 mm) tapered 13" (33 cm) tread depth with 7" (17.8 cm) integral riser
 - VICUTR with 2" (5.0 cm) wide contrasting color grit tape insert
 - VICUTRS with 2" (5.0 cm) wide contrasting solid rubber color insert strip
 - VICUTRP with 2" (5.0 cm) wide contrasting marbled rubber color insert strip
- **CFLTR & VICFLTR** (Visually Impaired) - Fast Lane Surface Texture Rubber Stair Tread with Integrated Riser, 2" (5.08 cm) hinged, square nose configuration, .210" (5.33 mm) to .153" (3.89 mm) tapered 13" (33 cm) tread depth with 7" (17.8 cm) integral riser
 - VICFLTR with 2" (5.0 cm) wide contrasting color grit tape insert
 - VICFLTRS with 2" (5.0 cm) wide contrasting solid rubber color insert strip
 - VICFLTRP with 2" (5.0 cm) wide contrasting marbled rubber color insert strip



THE ULTIMATE
FLOORING EXPERIENCE

Product Specification

096519 RESILIENT TILE FLOORING

RUBBER STAIR TREADS

- **HMT & VIHMT** (Visually Impaired) - Roundel Hammered Pattern Rubber Stair Tread, 2" (5.08 cm) hinged square nose configuration, .210" (5.33 mm) to .113" (2.87 mm) tapered 12-1/4" (31.12 cm) tread depth
 - VIIHMT with 2" (5.0 cm) wide contrasting color grit tape insert
 - VIIHMTS with 2" (5.0 cm) wide contrasting solid rubber color insert strip
 - VIIHMTTP with 2" (5.0 cm) wide contrasting marbled rubber color insert strip
- **HMTD & VIHMTD** (Visually Impaired) - Roundel Hammered Pattern Rubber Stair Tread, 2" (5.08 cm) hinged square nose configuration, .210" (5.33 mm) to .113" (2.87 mm) tapered 14" (35.6 cm) tread depth
 - VIIHMTD with 2" (5.0 cm) wide contrasting color grit tape insert
 - VIIHMTDS with 2" (5.0 cm) wide contrasting solid rubber color insert strip
 - VIIHMTDP with 2" (5.0 cm) wide contrasting marbled rubber color insert strip
- **RH-RD & VIRH-RD** (Visually Impaired) - Roundel Round Raised Disk Pattern Rubber Stair Tread, 2" (5.08 cm) hinged square nose configuration, .210" (5.33 mm) to .113" (2.87 mm) tapered 12-1/4" (31.12 cm) tread depth
 - VIRH-RD with 2" (5.0 cm) wide contrasting color grit tape insert
 - VIRHS-RD with 2" (5.0 cm) wide contrasting solid rubber color insert strip
 - VIRHP-RD with 2" (5.0 cm) wide contrasting marbled rubber color insert strip
- **RH-SQ & VIRH-SQ** (Visually Impaired) - Roundel Square Raised Disk Pattern Rubber Stair Treads, 2" (5.08 cm) hinged square nose configuration, .210" (5.33 mm) to .113" (2.87 mm) tapered 12-1/4" (31.12 cm) tread depth
 - VIRH-SQ with 2" (5.0 cm) wide contrasting color grit tape insert
 - VIRHS-SQ with 2" (5.0 cm) wide contrasting solid rubber color insert strip
 - VIRHP-SQ with 2" (5.0 cm) wide contrasting marbled rubber color insert strip
- **CN - (Sq & Rd)** Heavy Duty Diamond Rubber Stair Treads, 2" (5.08 cm) square nose or round nose configuration [designed for 3/4" (19 mm) stair nose radius], tapered from 0.240" (6.1 mm) to 0.140" (3.6 mm), 13" (33.02 cm) tread depth
 - VICN with 2" (5.0 cm) wide contrasting color grit tape insert.
 - VICNS with 2" (5.0 cm) wide contrasting solid rubber color insert strip
 - VICNP with 2" (5.0 cm) wide contrasting marbled rubber color insert strip
- **CNTR & VICNTR** (Visually Impaired) - Heavy Duty Diamond Rubber Stair Treads with Integrated Riser, 2" (5.08 cm) hinged, square nose configuration, 0.240" (6.1 mm) to 0.125" (3.2 mm) taper, 13" (33 cm) tread depth with 7" (17.8 cm) integral riser
 - VICNTR with 2" (5.0 cm) wide contrasting color grit tape insert.
 - VICNTRS with 2" (5.0 cm) wide contrasting solid rubber color insert strip
 - VICNTRP with 2" (5.0 cm) wide contrasting marbled rubber color insert strip
- **GS** Heavy Duty Smooth Rubber Stair Treads, Square nose configuration 1-7/8" (4.76 cm), 1/4" (6.35 mm) to 1/8" (3.17 mm) tapered 13-1/4" (33.66 cm) tread depth
- **G** Heavy Duty Smooth Safe-T-Grip Rubber Stair Treads, Square nose configuration 1-7/8" (4.76 cm), 1/4" (6.35 mm) to 1/8" (3.17 mm) tapered 13-1/4" (33.66 cm) tread depth, with two 1" wide grit tape inserts
- **VIG** Visually Impaired Heavy Duty Smooth Stair Treads, Square nose configuration 1-7/8" (4.76 cm), 1/4" (6.35 mm) to 1/8" (3.17 mm) tapered 13-1/4" (33.66 cm) tread depth, with a 2" (5.0 cm) wide contrasting color grit tape or solid color rubber insert.
- **S** Service Weight Rubber Stair Treads, Square nose configuration is 1-5/8" (4.66 cm) with a hinge, 3/16" (4.76 mm) to 1/8" (3.17 mm) tapered 13-1/4" (33.66 cm) tread depth. [Available with a Visually Impaired (VIS) 2" (5.0 cm) wide contrasting color grit tape or solid color rubber insert.]
- **SG** Sur-Grip Rubber Stair Treads Square nose configuration 1-5/8" (4.66 cm), 1-5/16" (3.33 cm) diameter 1/4" (6.35 mm) to 1/8" (3.17 mm) tapered 12-1/4" (31.12 cm) tread depth [Available with a Visually Impaired (VISG) 2" (5.0 cm) wide contrasting color grit tape or solid color rubber insert.]
- **SA** Service Weight Safe-T-Grip Rubber Stair Treads 1-5/8" (4.66 cm) square nose configuration, 3/16" (4.76 mm) to 1/8" (3.17 mm) tapered 13-1/4" (33.66 cm) tread depth, Two 1" (2.5 cm) wide grit tape inserts.

1.3.3. Physical Characteristics:

Lengths: 3', 3-1/2', 4', 4-1/2', 5', and 6' (.91 m, 1.07 m, 1.22 m, 1.37 m, 1.52 m, and 1.83 m) [Note: All VIRH-RD Series also available in 7 ft. (2.13 m) and 8 ft. (2.44 m) lengths] [Note: All VIRTR-RD and SQ. pattern also available in 7 ft. (2.13 m), 8 ft. (2.44 m), and 9 ft. (2.74 m) lengths]

THE ULTIMATE
FLOORING EXPERIENCE

Product Specification

096519 RESILIENT TILE FLOORING

RUBBER STAIR TREADS

2. PRODUCT PERFORMANCE AND TECHNICAL DATA

- **Tensile Strength:** ASTM D 412 - 1200 psi
- **Hardness:** ASTM D 2240 - Not less than 85 Shore A
- **Abrasion Resistance:** ASTM D 3389 - less than 1 gram weight loss
- **Slip Resistance:** ASTM D 2047 - Meets or Exceeds a static coefficient of friction of 0.8
- **Fire Resistance:**
ASTM E 648/NFPA 253 (Critical Radiant Flux): Class 1
ASTM E 662/NFPA 258 (Smoke Density), less than 450

3. INSTALLATION

The installation of Johnsonite Rubber Stair Treads should not begin until the work of all other trades has been completed, especially overhead trades. Areas to receive stair treads shall be clean, fully enclosed, weathertight, and maintained at a uniform temperature of at least 70°F for 24 hours before, during, and after the installation is completed. The stair treads and adhesives shall be conditioned in the same manner. Stair steps shall be smooth, flat, permanently dry, clean and free of all foreign material, such as dust, paint, grease, oils, solvents, curing and hardening compounds, sealers, asphalt, and old adhesive residue. Stair Treads may be installed on any smooth, dry interior step. Do not install on exterior steps subject to weather. Stair shape shall conform closely to stair tread contour, especially where the flat part of the tread joins the nosing. An epoxy-caulking nose-filler shall be applied to ensure a tight fit and eliminate any open spaces between the step edge and stair tread nosing. Stair treads shall be trimmed to within 1/16" of the riser and stringer to allow for expansion. Adhesives shall be applied per Johnsonite's instructions. The stair tread and nosing portion of the stair tread shall be bonded directly to the step surface. **Do not overlap the nosing over resilient riser material.** Stair treads shall be rolled, with a J-hand roller, after installation, to ensure proper bonding.

3.1. Adhesives:

Johnsonite 965 Flooring & Tread Adhesive

Porous Substrates: 1/16" square-notched trowel
(Approximately 125 sq ft /gal)

Non-Porous Substrates: 1/16" V-notched trowel
(Approximately 145 sq ft /gal)

Important: This adhesive is substrate porosity sensitive. Determine if the substrate is porous or non-porous prior to application of the adhesive and installation of the flooring products and follow the appropriate instructions.

Johnsonite 945 Contact Bond Adhesive

Application: Brush or roller

Coverage: Approx. 360 sq ft/gal

Johnsonite 930 Two-Part Epoxy Caulking Compound

Application - Gun, knife, or 13-1/2 ounce cartridge (Use Johnsonite 530 dual-cartridge dispenser gun with cartridge)

Coverage: Approx. 250 linear ft/gal or 50 linear with a 1/4" diameter bead per 13-1/2 ounce cartridge

4. AVAILABILITY AND COST

Available through authorized Johnsonite distributors nationwide.

5. WARRANTY

Limited 1 year warranty against defects in manufacturing and workmanship. For complete details, contact Johnsonite or an authorized Johnsonite distributor.

6. MAINTENANCE

72 hours after installation is completed, initial maintenance procedures must be implemented in accordance with manufacturer's requirements. Refer to Johnsonite Rubber Floor Tile and Rubber Stair Tread Maintenance Instructions for complete maintenance details.

7. TECHNICAL SERVICES

Samples: Submittal samples for verification and approval available upon request from Johnsonite. Samples shall be submitted in compliance with the requirements of the Contract Documents. Accepted and approved samples shall constitute the standard materials which represent materials installed on the project.

For current Installation and Maintenance Instructions, Product Specifications, and other technical data, visit us on the web at www.johnsonite.com or contact Johnsonite at 1-800-899-8916.



Product Specification

Section 096513

BaseWorks™ Thermoset Rubber Wall Base

1. PROPRIETARY PRODUCT/MANUFACTURER

1.1. Proprietary Product: Thermoset Rubber Wall Base

1.2. Manufacturer:

Johnsonite, Inc.	Phone	(800) 899-8916
16910 Munn Road		(440) 543-8916
Chagrin Falls, Ohio 44023	Tech:	Ext 9297
Web: www.johnsonite.com	Samples:	Ext 9299
Email: info@johnsonite.com	Fax:	(440) 543-8920

1.3. Proprietary Product Description:

1.3.1. **Construction:** Johnsonite BaseWorks™ Thermoset Rubber Wall Base is manufactured from a proprietary rubber formulation designed specifically to meet the performance and dimensional requirements of ASTM F-1861, Type TS, Group 1 (solid), Style A and B, Standard Specification for Resilient Wall Base.

1.3.2. Physical Characteristics:

Traditional Wall Base Styles:

- **Thickness:** .125" (3.17 mm)
- **Style:** Straight (Toeless) and Coved (Toe) profiles
- **Heights:** 2-1/2" (6.35 cm), 4" (10.16 cm), and 6" (15.24 cm)
- **Lengths:** 4' (1.22 m) straight lengths and 120' (36.58 m) coiled lengths for all profiles except, 6" x .125" profiles packaged in 100' (30.48 m)-coiled lengths or 4' (1.22 m) straight lengths.

Inside and outside corners available with 4" (10.16 cm) returns packaged 25 per carton.

2. PRODUCT PERFORMANCE AND TECHNICAL DATA

- Meets or exceeds the performance requirements for resistance to heat/light aging, chemicals, and dimensional stability when tested to the methods, as described, in ASTM F-1861.
- **Flexibility:** ASTM F 137 - Will not crack, break, or show any signs of fatigue when bent around a 1/4" (6.4 mm) diameter cylinder.
- **Resistance to Light:** ASTM F 1515 - Passes $\Delta E \leq 8.0$
- **Chemical Resistance:** ASTM F 925 Passed - Acetic Acid 5%, Isopropyl Alcohol 70%, Sodium Hydroxide 5%, Hydrochloric Acid 5%, Ammonia 5%, Phenol 5%, and Acid Sulfuric 5%.
- **Fire Resistance:**
ASTM E 84/NFPA 255 (Flame/Smoke) - Class B, < 450
ASTM E 648 (NFPA 253): Critical Radiant Flux - Class 1

- **Chemical Resistance (ASTM F 925):** Passed - 5% Acetic acid, 70% Isopropyl alcohol, Sodium hydroxide solution (5% NaOH), Hydrochloric acid solution (5% HCl), Sulfuric acid solution (5% H₂SO₄), Household ammonia solution (5% NH₄OH), Household bleach (5.25% NaOCl), Disinfectant cleaner (5% active phenol)

3. INSTALLATION

Johnsonite BaseWorks Wall Base and adhesives must be site conditioned at room temperature for a minimum of 48 hours prior to, during, and after installation. Room temperature must be maintained between 65° and 85°F (18° and 30°C) with HVAC system operating. A minimum temperature of 55°F (13°C) must be maintained afterwards. The ambient relative humidity should be between 40% and 60%.

All walls must be clean, smooth, flat and dry. The surface must be free of all dust, loose particles, solvents, paint, grease, oil, wax, alkali, sealing/curing compounds, old adhesive, and any other foreign material, which could affect installation. Remove existing adhesive mechanically - do not use chemical adhesive removers or solvents. Fill all depressions, cracks, and other surface irregularities with a good quality patching compound.

NOTE: Contamination on the substrate can cause damage to the thermoset rubber wall base material. Permanent and non-permanent markers, pens, crayons, paint, etc., must not be used to write on the back of the wall base material or used to mark the substrate as they could bleed through and stain the wall base material. If these contaminants are present on the substrate they must be mechanically removed prior to the installation of the thermoset rubber wall base material.

Caution: Do not use liquid solvents or adhesive removers.

Do not install Johnsonite BaseWorks Wall Base over vinyl wallcoverings.

Do not install Johnsonite BaseWorks Wall Base over non-porous surfaces with Johnsonite 960 Wall Base Adhesive. Utilize Johnsonite 946 Premium Contact Adhesive following the non-porous application instructions for all non-porous surface installations.

3.1. Adhesives:

Porous Surfaces - 960 Cove Base Adhesive

- 1/8" square notch trowel
- Spread rate average:
4" height - 225 linear feet/gallon
6" height - 125 linear feet/gallon

**Product Specification**

Section 096513

BaseWorks™ Thermoset Rubber Wall Base**Non-porous Surfaces - 946 Premium Contact Adhesive**

Application: Brush or roller

Coverage:

- o 1 kg Unit (0.95 Qt.) – 24 to 36 Sq. Ft. Per Unit
- o 6 kg Unit (1.44 Gal.) – 144 to 215 Sq. Ft. Per Unit

- 3.2. **Installation Manual:** Refer to Johnsonite Wall Base Installation Instructions for complete installation details.

4. AVAILABILITY AND COST

Available through authorized Johnsonite distributors nationwide.

5. WARRANTY

Limited 1 year warranty. For complete details, contact Johnsonite or an authorized Johnsonite distributor.

6. MAINTENANCE

Refer to Johnsonite Wall Base Installation Instructions for complete maintenance details.

7. TECHNICAL SERVICES

Samples: Submittal samples for verification and approval available upon request from Johnsonite. Samples shall be submitted in compliance with the requirements of the Contract Documents. Accepted and approved samples shall constitute the standard materials which represent materials installed on the project.

For current Installation and Maintenance Instructions, Product Specifications, and other technical data, visit us on the web at www.johnsonite.com or contact Johnsonite at 800-899-8916.

MAINTENANCE OF SHAW CONTRACT GROUP CARPETS

Shaw Contract Group tile and broadloom carpets are quality engineered to provide a long useful life and enhance the indoor environment. Carpet offers many advantages over other flooring systems, such as reduced fatigue, sound absorption, and lower life cycle costs.

From the start, the carpet maintenance program should be considered part of the carpet buying decision. If proper maintenance is neglected, the carpet's appearance will suffer, shortening the carpet's useful life and raising long term costs.

A comprehensive carpet care program consists of four elements:

- * Reduction of soil entering the building
- * Removal of dry soil
- * Removal of spots and spills
- * Cleaning by high performance hot water extraction

* ***Please note that the information in this booklet pertains to most carpets made of synthetic or man-made fibers in commercial installations. Some procedures may not be suitable for wool or wool-blend carpets or printed carpets. For these type carpets, please see the special appropriate maintenance brochure from the Shaw Industries Technical Services Department.***

* ***This document contains specific procedures for maintenance of printed carpets.***

THE IMPORTANCE OF PLANNING

A successful maintenance program starts with the selection of carpet that meets specific performance requirements. Attributes include construction, backing, yarn, dye type, and color. Color and pattern are major factors in the perception of a successful maintenance program. The visual degree of soiling is measured as color contrast. The best soil hiding colors are usually medium to dark shades. These are best specified for known areas having severe traffic and soil.

Carpet maintenance must be established as a scheduled program, rather than being a random series of reactions to soiling conditions and infrequent cleaning. Virtually every complaint of poor appearance, rapid soiling, and many times poor performance has been shown to be related to a lack of planning and control of the maintenance program.

The most important consideration when planning a maintenance program is the budget. Like other expensive furnishings or equipment, carpet represents a substantial investment for any facility and deserves adequate care to prolong its effective life. If the carpet maintenance budget is set unrealistically low, the carpet will need to be replaced prematurely.

Tailor the design of the program to the amount of traffic and type of soiling which vary by area. Due to higher traffic levels, entrance lobbies, elevators, and hallways will need more care than offices. Food service areas and entrances will require more effort due to the more difficult soiling conditions. Consult the chart for suggested frequencies by traffic levels.

Traffic Level	Vacuum	Spot Clean	Hot Water Extraction
Light	2-3 times/week	As needed	Annually
Medium	Daily	As needed	Twice/year
Heavy	1+ times/day	As needed	Quarterly
Extra Heavy *	1+ times/day	As needed	Minimum Monthly/as needed

Light traffic = private offices & cubicles

Medium traffic = shared offices, interior hallways & conference rooms

Heavy traffic = entrances, elevators, main hallways, break rooms, work/copy rooms & mailrooms

* Extra Heavy = airports & entries to hospitals, malls & theaters *extra heavy traffic & soiling require frequent attention

WHAT YOU CAN EXPECT FROM YOUR CARPET IN THE REAL WORLD

Although Shaw Industries products are designed for specific applications and are tested to withstand the tremendous beating that carpet receives in some uses, there are some conditions where appearance change must be expected. Carpet and other flooring materials where the oily material from asphalt sealers is tracked into the building may become yellowed over time. This material stains not only carpet but other flooring materials as well. It is virtually impossible to remove all of this material once it has penetrated the fiber of any carpet. Walk off mats and periodic cleaning can reduce this phenomenon. When sealing asphalt parking lots specify a high quality sealer and ask the vendor for a warranty that this will not occur.

Areas where large amounts of sandy soil enter the building may become dull in appearance over time. This is due to abrasion of the fiber surface, reducing the reflection of light. This is minimized by frequent vacuuming.

REDUCTION OF SOILING

One of the most critical aspects of maintenance is the use of walk-off mats at building entrances. Mats are also one of the least understood and neglected parts of the maintenance program. Walk-off mats greatly reduce the amount of soil carried into a building by foot traffic. Other areas where mats are beneficial are service entrances with direct contact to the outside, from the hard surface area in a kitchen to the carpeted dining area in a restaurant, or at entrances from plant facilities into the offices. Various studies have shown that the cost of removing a pound of soil from a building ranges up to \$500 or more! Clearly, it is far cheaper to stop the dirt at the door.

The choice of mats is important because the cheaper mats do a poor job of trapping soil and have a short life span. Walk-off mats fall into two categories; those designed to remove and trap gritty soil and those intended to absorb water during wet weather. They should be used in combination.

Good soil removal mats have a coarse texture, are able to brush soil from shoes, and can hold large amounts of soil in their pile. The water absorbent mat is used inside to prevent tracked in moisture from getting to the carpet. A wet carpet acts like a giant shoe cleaner and soils rapidly. When both types of mats are used in combination, they should always be placed so that incoming traffic passes over the soil removal mat first, because the absorbent types have very little soil holding ability.

For mats to continue to trap soil, they should be cleaned on a regular basis, more frequently than the carpet. If accumulated soil is not removed, the mat will become overloaded and cannot prevent soil from

entering the building - the mat may even become a source of soil itself. When a building is new or still under construction, soil may be tracked in from unfinished grounds so the mats need to be cleaned more often.

REMOVAL OF DRY SOIL

Vacuuming is the **most significant element** in the maintenance of carpet and the overall appearance of the facility. Research has shown that 85% of the soil tracked into a building is dry, and the other 15% is oily. Vacuums are designed to remove the dry soil. Walking on soiled carpet permits the soil particles to work their way down into the pile where they are more difficult to remove. Frequent vacuuming removes soil particles from the surface before this happens. Heavily trafficked areas, such as entrances and major corridors, should be vacuumed at least once a day. Areas with less traffic such as offices should be vacuumed every other day depending upon conditions.

Vacuum Cleaner Recommendations:

1. We only recommend use of vacuums certified in **The Carpet and Rug Institute (www.carpet-rug.org) Vacuum Cleaning Indoor Air Quality Program**. Vacuums specifically designed for commercial installations offer characteristics which help meet the demands of a good maintenance program.
2. For carpet tile and carpets that are **glued directly to the floor without cushion**, a vacuum with a rotating cylindrical brush, rather than a beater bar, should be used to agitate the pile and loosen the soil. Beater bars can damage the pile of direct-glued carpet if the machine height adjustment is set too low. This can also damage the vacuum.
3. Vacuums with either a beater bar or rotating brush can be used for carpet installed over pad, or with attached cushion backings. These vacuums are also recommended for double stick installations where the carpet is glued to the pad.
4. Bags that fill from the top are preferred over those that fill from the bottom. Replaceable paper bags or paper liners for cloth bags are better filters than cloth bags alone because they can trap more of the small particles that cloth bags allow to pass back into the air. Many vacuums can also be used with **micro filtration or high efficiency bags** which capture even smaller particles which tend to be related to allergy complaints and can also reduce the need for dusting. Check bags frequently and replace when 1/2 to 2/3 full to avoid a decrease in efficiency. When changing bags, also check the belt and replace if loose or worn.
5. A good vacuum is vital to prolonging the life of your carpet. A cheap vacuum can remove surface dirt but may not effectively remove the hidden particles embedded in the pile. This can lead to rapid appearance loss and complaints of poor product performance. A hundred dollars saved on the price of a vacuum can easily cost thousands of dollars in reduced useful life of the carpet.

PILE LIFTING

Between cleanings, regular use of a **pile lifter** can remove deeply embedded dry sand and soil, help stand up the pile and renew the appearance of the carpet in high traffic areas such as traffic funnel zones, elevators, and lobbies. A pile lifter is an upright two motor vacuum with a large, adjustable motor driven brush, a high suction vacuum motor, and a sand trap. Using a pile lifter in traffic lanes just prior to cleaning removes the deeply embedded soil and opens up the pile so the hot water extraction can be more effective. **Follow the pile lifting with a thorough vacuuming.**

SPOT AND SPILL REMOVAL

All maintenance procedures mentioned thus far have been **planned**; spot and stain removal is the reaction to an **unplanned** incident. Therefore, it is desirable to have the needed materials handy by planning ahead of time. The professional cleaning companies have spot removal kits in convenient carrying cases that contain all the necessary materials. For assistance with specific stain removal procedures, contact Shaw Industries Technical Services Department through Inforum at 877-502-7429.

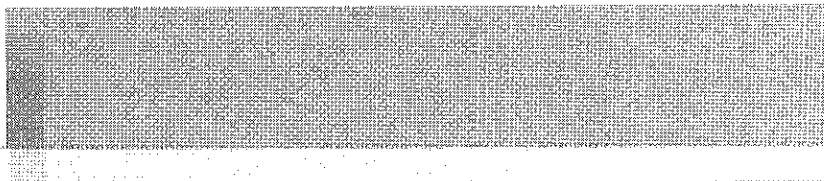

General Instructions:

Spot removal products that have been tested and certified in the Carpet and Rug Institute (CRI) Seal of Approval Program for cleaning products are recommended for specific spots. (Reference www.carpet-rug.org) Additional spot removal procedures are listed below if professional and CRI certified products are not available:

* Scoop up any solids gently with a spoon or dull knife. Absorb wet spills as quickly as possible by blotting with **white** paper or cloth towels.

* Always blot, **never scrub or rub abrasively**, because it may create a fuzzy area. When blotting, work from the outer edge in toward the center of the spot to avoid spreading the spill and enlarging the problem.

* Thorough removal of both the stain material and the detergent residue is critical to prevent re-soiling. Water extraction is the best way to accomplish this. Many cleaning equipment manufacturers offer small extraction machines specially designed for spot cleaning. These are small, lightweight and highly portable. They do an excellent job of rinsing after spot cleaning. They are also an excellent way to deal with body fluids on the carpet. For additional information on these machines call the Shaw Technical Services Department.

* Place several layers of white towels on the spot to draw out any remaining moisture. Weight them down with a heavy object that will not transfer color, such as a plastic jug of water.

Removal Procedures:

A. WATER SOLUBLE STAINS - Absorb as much as possible with white towels. Blot the affected area with more towels dampened with cool water until no more color transfers to the towels. If any of the stain remains, use a detergent solution of 1/2 teaspoon (no more) of **CLEAR** liquid hand dishwashing detergent (do not use those containing lanolin or hand lotions) to a quart of water in a clean spray bottle. You may also use a general purpose spot cleaner with a pH less than 10.

For printed carpets, do not use cleaning agents with a pH higher than 8. Spray lightly onto the spot and blot repeatedly with white towels. **Rinse thoroughly** by spraying with clean water, and then blot or extract. Do not use too much detergent because the residue will contribute to rapid re-soiling.

A-1. Either: apply a white vinegar solution (one part white vinegar to one part water) to a white towel and blot or spray onto spot. Continue as in "**A**" or use a slightly acidic spotter made for coffee, tea and other tannin stains rather than the detergent.

A-2. Either: apply a solution of household ammonia (one tablespoon of ammonia to one cup water) to a white towel and blot or spray onto spot. Continue as in "**A**" or use an alkaline spotter made for removing blood and protein stains rather than the detergent. **Do not use on printed styles.**

B. GREASE- Blot as much as possible with white towels. Apply a solvent designed for grease removal to a towel and blot. **Use sparingly and do not pour or spray directly** on the carpet pile as damage to the backing or adhesive underneath may result. A better option is the use of a gel solvent. The advantage of the gel is that it remains on or near the surface where the grease is. The application is much more controllable and has two distinct advantages. By remaining in the area where gel is applied, it allows additional dwell time for the contaminant to soften and by not penetrating to the backing, there is no risk of carpet delaminating.

Use the towels to transport the solvent to the carpet. Repeat until no more color transfers to the towel. Protective gloves should be worn because the solvent will quickly remove oils from the skin and may result in irritation. Provide adequate ventilation and **do not use flammable solvents!** Rinse thoroughly by spraying with clean water, and then blot or extract. If needed, continue with procedures in "**A**".

C. FREEZE areas with chewing gum and candle wax with ice or a commercially available product in an aerosol can. Shatter with a blunt object and vacuum before the chips soften. Follow up with solvent as in "B". A better option is the use of a gel solvent.

D. Several specialty spotting products are available from cleaning industry suppliers to remove difficult stains such as Betadine, food dyes, mustard, etc... For specific specialty products, contact Shaw Technical Services through Inforum at 877-502-7429.

E. RUST can be removed in most cases with a 10% solution of oxalic acid which is available under several brand names at most stores selling cleaning products. Stubborn cases require 5% hydrofluoric acid which is difficult to obtain and dangerous to use. Both should be used with **caution** by a trained professional.

RECOMMENDED PROCEDURES BY STAIN TYPE

STAIN	REMOVAL PROCEDURE
Adhesive, Carpet*	B, A,
Alcoholic Beverages	A
Asphalt	B
Beer	A
Betadine*	A, D
Blood, wet	A
Dry	A-2
Butter	B
Chewing Gum	C
Chocolate	A-2
Coffee*	A-1, D
Cola Drinks	A
Cosmetics*	B, A, D
Crayon	B
Deicer, Salt	Vacuum, A
Excrement	A
Food Dyes*	A, D
Furniture Polish	A, B

STAIN	REMOVAL PROCEDURE
Grease, Auto	B
Food	A
Ink, Ballpoint	B
Permanent	B, D
Washable*	A
Lipstick	B
Milk	A
Mustard*	A, D
Nail Polish	Polish Remover
Paint, Latex, Wet	A
Latex, Dry	B
Oil	B
Rust*	E
Tea*	A-1, D
Toner, Copier	Vacuum, A
Unknown*	B, A
Urine	A-1
Vomit	A-1
Wax	C
Wine	A-2

* Consulting a Trained Professional Cleaner is an option

CLEANING

Even with thorough vacuuming, cleaning is necessary to remove the 15% of soil which is the oily type material, as well as that which the vacuum cannot remove. In order to maintain acceptable appearance, the carpet **must** be cleaned on a periodic basis to prevent the carpet from becoming so dirty that it can no longer be cleaned satisfactorily. The frequency of cleaning must be adjusted to the rate at which soil accumulates; therefore, heavily trafficked areas typically require more frequent cleaning, as do areas with less traffic but more soil.

When the color of the carpet begins to look dull, it is time to clean the carpet. The traffic lanes will show this first. If the carpet is cleaned before it becomes excessively soiled, the cleaning will be more successful and a much easier task. This is especially important in places where oily soil is prevalent, such as the areas near streets or asphalt parking lots, and those around cooking or dining facilities. Oil tends to oxidize slowly, forming a sticky material similar to varnish which becomes nearly impossible to remove as it ages.

Another stubborn problem is the salt or deicer from snow melt which accumulates in the carpet over winter. Salt pulls moisture from the air and prevents the carpet from drying as quickly as it normally would. Remember that damp carpet acts like a wet sponge to clean shoes and collect soil faster. The resulting black discoloration in the traffic lanes requires pretreatment with a traffic lane cleaner to break down the soiling and the use of hot, not warm, water to dissolve and remove the salt and soil. Residue from snow melt can cause possible damage, including discoloration. Salt is also an abrasive substance which can cause damage to the fibers.

The Cleaning System:

A number of cleaning systems are available; their effectiveness varies widely. When choosing the cleaning system, the important considerations are:

- It must clean effectively
- It must not damage the texture of the carpet
- It must not leave excessive residues of cleaning materials.

Shaw Industries recommendations are based on significant laboratory work and many years of experience in the field. **Shaw recommends only the high performance hot water extraction system, which research indicates provides the best capability for cleaning.** This system is commonly referred to as "steam cleaning" although no steam is actually generated. The process consists of applying a cleaning agent onto the pile, and using water in the extractor to recover the used solution and soil. This can be done from a truck-mounted unit outside the facility with only the hose and wand brought inside, or where a truck-mounted unit cannot reach, by a portable system brought into the facility.

A list of cleaning products that have been tested and certified in the Carpet and Rug Institute (CRI) Seal of Approval Program may be found at www.carpet-rug.org. For additional assistance contact Inforum at 877-502-7429.

The Hot Water Extraction method using high performance equipment should be the **primary** scheduled method to clean carpets. Shaw Industries recommends the use of Hot water extraction equipment which has obtained a Gold Rating in the **Carpet and Rug Institute (CRI) Seal of Approval Program. A list of equipment that has obtained the Gold Rating may be found at www.carpet-rug.org.**

Self-contained, walk-behind machines are another type of hot water extraction equipment commonly used. They apply the cleaning solution at a rate which is balanced with the recovery capability of the machine. This type machine is often employed where cleaning is done by in-house maintenance staffs.

Since these machines cannot equal the performance of high performance extractors, their use should be scheduled as an interim frequency supplemented by periodic high performance cleaning.

When necessary interim cleaning systems are successful when used to supplement the extraction program. These interim cleaning processes help enhance the carpet's appearance between deep cleanings.

Low moisture encapsulation systems are also interim cleaning processes that enable the carpet's appearance to be improved and returned to service in a short amount of time. The cleaning agent is agitated into the carpet's pile with a mechanical brush, allowed to dry and vacuumed to remove the encapsulated soil from the carpet. In conjunction with scheduled Hot Water Extraction cleanings, the low moisture systems can help maintain a satisfactory appearance.

SHAW DOES NOT RECOMMEND!

"Bonnet" Systems:

The name for these systems is derived from the rotating bonnet of terry cloth or other absorbent material used to agitate the pile and pick up soil. A detergent solution is sprayed onto the pile, and is then worked with the bonnet attached to a rotary floor polisher. It is at best a temporary appearance enhancement because it only absorbs at the surface and does no real extraction of deep soil. **SHAW DOES NOT ADVOCATE THIS SYSTEM.** It is **not substitute for hot water extraction.**

It has very limited capability for soil removal and often leaves most of the detergent in the pile. The spinning bonnet may distort the pile of cut pile carpets and leave distinct swirl marks.

SHAW'S EXPERIENCE HAS BEEN THAT MORE CUSTOMER SOILING COMPLAINTS RESULT FROM THIS SYSTEM THAN ALL OTHER CAUSES COMBINED!

The bonnet system may damage the edges of some carpet tiles.

Water recycling machines

Shaw Industries does not recommend any cleaning machine which continuously recycles the cleaning solution. A growing body of experience is showing that although the large particles are filtered out, the soluble materials, including detergents and soluble contaminants are distributed over the whole area. With repeated cleanings these materials become more concentrated and begin to cause rapid resoiling.

CHOOSING A PROFESSIONAL CLEANER

One way to locate a nearby professional carpet cleaner who uses a hot water extraction system is to contact the **Institute of Inspection, Cleaning & Restoration Certification (IICRC)** at 800-835-4624 or www.iicrc.org.

This organization maintains a national directory of independent professional cleaners who are trained and certified in a variety of cleaning specialties. **You must specifically request a professional cleaner using hot water extraction.** IICRC certified firms with the "Master Cleaner" certification are preferred.

BASIC GUIDELINES FOR IN-HOUSE MAINTENANCE

If you choose to maintain your carpet using in-house personnel, here are some guidelines to follow. For a good reference describing carpet cleaning and the hot water extraction method specifically, read the *Carpet Cleaning Standard*, (S100) by the IICRC, available at the number listed above.

1. Thoroughly vacuum the area to be cleaned before the hot water extraction to remove as much dry soil as possible. Use a pile lifter if necessary in high traffic areas.
2. Remove spots and stains using the procedures above or a commercially available spot removal kit. Pre-treat the heavily soiled areas and traffic lanes with traffic lane cleaner **certified in the Carpet and Rug Institute (CRI) Seal of Approval Program (www.carpet-rug.org)**. Agitate the carpet using carpet rake or agitation equipment. This allows the cleaning agent to penetrate. A minimum of ten minutes of dwell time is recommended to allow the cleaning agent time to loosen contaminants. Although it is advisable to minimize the use of solvents, many traffic lane cleaners do contain some solvents to help remove the stubborn oily dirt often found in traffic areas. Treat a small area and extract the liquid before the traffic lane cleaner dries.
3. On most commercial carpets, use a detergent with a pH less than 10, preferably near 9, and with a minimum of non-sticky residue. For *printed carpets*, use a detergent solution that has a pH between 6 and 8.

Cleaning products that have been tested and certified in the Carpet and Rug Institute (CRI) Seal of Approval Program for Cleaning Products are recommended. For additional assistance contact Inforum at 1-877-502-7429.

Your detergent selection is important. It is even more important to remove all the detergent you put into the carpet. A detergents' ability to bind to particles of soil and oil is what makes cleaning happen. However, the detergent residue continues to attract and hold soil even after drying. Increasing the amount of detergent beyond the recommended level does not increase cleaning performance, but makes the complete removal of detergent more difficult. **Excessive detergent residue is the most common cause of accelerated resoiling complaints. Shaw does not recommend the use of cleaning agents with optical brighteners.**

4. **Avoid over-wetting** the carpet. Prolonged dampness may cause discoloration, promote growth of mildew and bacteria in the carpet, or cause separation of the backing. This can be controlled by a combination of proper equipment and operator training.
5. Do **not** use any silicone-based anti-soil treatments on carpet produced by Shaw.
6. **Reduce drying time** by using several fans or air movers to move air across the carpet in combination with a dehumidifier or air conditioner to pull moisture out of the air. Carpet should be completely dry within 12 hours or less.

tile specifications

style name	ambient tile
style number	59330
construction	multi-level pattern loop
fiber	eco solution q® nylon
dye method	72% solution dyed / 28% yarn dyed

english

metric

pattern repeat	none	
tufted weight	24.0	813.74 g/m ²
gauge	1/12	47.24 per 10 cm
stitches per inch	11.0	43.31 per 10 cm
finished pile thickness	0.132	3.35 mm
total thickness	0.287	7.29 mm
average density	6545	12.19 kilotex
product size	24" x 24"	60.96 cm x 60.96 cm
primary backing	synthetic	
secondary backing	ecoworx® tile	
protective treatments	ssp® shaw soil protection	
gsa approved product	yes	



testing

radiant panel	Class I
nbs smoke	less than 450
electrostatic propensity	less than 3.5 kv

warranties

lifetime commercial limited

installation method

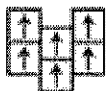

ashlar

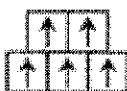

brick



monolithic



quarter turn



random

coordinating products

classical tile, jazz tile, electronica tile, silence tile

environmental certification

green label plus certification number	glp9968
nsf140 platinum	
cradle to cradle silver certified	



shaw contract group® roll over each term to see a definition

ambient tile

eco impacts

end of life

recyclability	100% recyclable
shaw closed looped recycling	0.0%
environmental guarantee	free pick up & recycling
To recycle call 800.509.SHAW	

materials

ingredients

face fiber	nylon 6
dye method	96% Solution Dyed, 4% Yarn Dyed
backing	polyolefin composite
surface treatments	non c8 fluorocarbon chemistry
does not contain PVC, phthalates, or PBD/PBDE	

recycled content

total recycled content (by weight)	44.4 %
pre-consumer	32.5 %
post-consumer	11.9 %
bio-based/rapidly renewable content (by weight)	0.0 %
packaging	100% recyclable
country of origin (manufacturer)	USA

Meets or exceeds all local and national regulations in country of manufacture.

Manufactured in an ISO9001 & ISO14001 certified facility or equivalent.

Recycled content is calculated using system allocation, mass balance, and direct insertion.

The actual recycled content in this product will likely vary. For more information email info@shawgreenedge.com.

third party certifications

MBDC cradle to cradle	Silver Certified
NSF 140	Platinum Certified
CRI green label plus	GLP9968
USGBC LEED	contributes
Building Research Establishment	certified
Good Environmental Choice Australia	certified
Singapore green label	Certified 039-003

social responsibility

Shaw and our people provide financial support, volunteer service and leadership for charitable and civic organizations in the communities where we work and live. Additionally, we strive to adhere to all applicable laws regarding labor, discrimination and harassment, wages and benefits, health and safety, diversity and equal opportunity.

Sustainability Through Innovation™ That's the Shaw Green Edge®

tile specifications

style name	blend tile
style number	5T025
construction	multi-level pattern cut/loop
fiber	eco solution q® nylon
dye method	50% solution dyed / 50% yarn dyed

english

metric

pattern repeat		
tufted weight	34.0	1,152.80 g/m²
gauge	1/12	47.24 per 10 cm
stitches per inch	11.0	43.31 per 10 cm
finished pile thickness	0.162	4.11 mm
total thickness	0.299	7.59 mm
average density	7556	14.07 kilotex
product size	24" x 24"	60.96 cm x 60.96 cm
primary backing	synthetic	
secondary backing	ecoworx® tile	
protective treatments	ssp® shaw soil protection	
gsa approved product	yes	



testing

radiant panel	Class I
nbs smoke	less than 450
electrostatic propensity	less than 3.5 kv

warranties

lifetime commercial limited

installation method



coordinating products

technique tile, vanish tile, blend tile

environmental certification

nsf140 platinum
cradle to cradle silver certified



eco impacts

end of life

recyclability	100% recyclable
shaw closed looped recycling	100.0%
environmental guarantee	free pick up & recycling
To recycle call 800.509.SHAW	

materials

ingredients

face fiber	nylon 6
dye method	93% solution dyed / 7% yarn dyed
backing	polyolefin composite
surface treatments	non c8 fluorocarbon chemistry
does not contain PVC, phthalates, or PBD/PBDE	

recycled content

total recycled content (by weight)	44.5 %
pre-consumer	31.1 %
post-consumer	13.4 %
bio-based/rapidly renewable content (by weight)	0.0 %
packaging	100% recyclable
country of origin (manufacturer)	USA

Meets or exceeds all local and national regulations in-country of manufacture.

Manufactured in an ISO9001 & ISO14001 certified facility or equivalent.

Recycled content is calculated using system allocation, mass balance, and direct insertion.

The actual recycled content in this product will likely vary. For more information email info@shawgreedge.com.

third party certifications

MBDC cradle to cradle	silver certified
NSF 140	platinum certified
CRI green label plus	certified glp9968
USGBC LEED	contributes
Building Research Establishment	certified
Good Environmental Choice Australia	certified
Singapore green label	certified 039-003

social responsibility

Shaw and our people provide financial support, volunteer service and leadership for charitable and civic organizations in the communities where we work and live. Additionally, we strive to adhere to all applicable laws regarding labor, discrimination and harassment, wages and benefits, health and safety, diversity and equal opportunity.